

High Quality Locks

Made in Germany

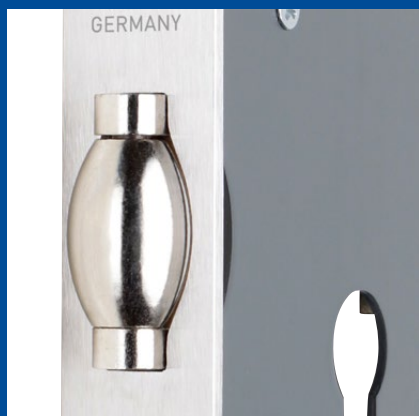

About CES

Made in Germany – made by CES	6
Certificates & Product Declaration	7
Our certified products	8
Features	9
Our product highlights	10

Product range

Locks for solid leaf doors	13
Locks for narrow frame doors	55
Locks for refurbishment	65
Striking plates	69
Overview “Which striking plate fits which lock?”	70

Useful Information

Pictograms	77
Explanation of DIN direction	78

Product list

Solid leaf doors (wooden & steel doors) for fire protection doors and escape routes

9100	Mortise Sashlock for single-leaf fire-rated doors	14
9100SP	Mortise Sashlock with Anti-thrust latch for single-leaf fire-rated doors	15
9100F	Mortise Nightlatch-Lock for single-leaf fire-rated doors	16
9100FL	Mortise Latch-Lock for single-leaf fire-rated doors	17
9100F-SP	Mortise Nightlatch-Lock with Anti-thrust latch for single-leaf fire-rated doors	18
9100R	Mortise Deadlock for single-leaf fire-rated doors	19
9100WC	Mortise Bathroom-Lock for single-leaf fire-rated doors	20
9100E	Mortise Escape-Lock with panic-function E for single-leaf fire-rated doors	21
9100E-SP	Mortise Escape-Lock with Anti-thrust latch for single-leaf fire-rated doors	22

for industrial buildings

7734	Mortise Lock with transmission bar, medium version (fixed forend)	30
7790	Mortise Bathroom-Lock, medium version (fixed forend)	31
7700-01	Mortise Latch-Lock, medium version (fixed forend)	32
7730-02	Mortise Deadlock, medium version (fixed forend)	33
7734-01	Mortise Nightlatch-Lock with transmission bar, medium version (fixed forend)	32
77.34	Mortise Lock with transmission bar and screwed forend on lockcase	34
9034	Mortise Lock with transmission bar, heavy duty version	35
9090	Mortise Bathroom-Lock, heavy duty version	35
334	DIN Contract business Sashlock	36
390	DIN Contract business Bathroom-Lock	36
334SL	DIN Contract business Sashlock with bushed follower	36
390SL	DIN Contract business Bathroom-Lock with bushed follower	36

300-01	DIN Contract business Latch-Lock	37
300-01SL	DIN Contract business Latch-Lock with bushed follower	37
2500	Mortise Latch-Lock with small lock case	38
2730	Mortise Deadlock with small lock case	39
2700	Mortise Bathroom-Lock with small lock case	39

for swing and sliding doors

4530	Swing-door Lock with roller-latch with large lock case	42
4590	Swing-door Lock with roller-latch with large lock case	42
4700	Swing-door Lock with roller-latch with small lock case	43
4730	Swing-door Lock with roller-latch with small lock case	44
4790	Swing-door Lock with roller-latch with small lock case	44
5530N	Sliding-door Lock with compass-bolt	45
5590	Sliding-door Lock with compass-bolt	45
5830	Sliding-door Lock with hook-latch	46
5800	Sliding-door Lock with hook-latch	46

for special doors

8030	Special Mortise Lock with 3 bolts without transmission bar	51
8034	Special Mortise Lock with 3 bolts with transmission bar	51
8230	Mortise Lock for radiation shielding doors without transmission bar	52
8234	Mortise Lock for radiation shielding doors with transmission bar	52
9003	Sliding door Lock for operating theatres with shoot bolt guide behind the forend	53
9004	Sliding door Lock for operating theatres with shoot bolt guide at backset	53
9005	Sliding door Lock for operating theatres with shoot bolt guide behind the forend	53
9006	Sliding door Locks for operating theatres with shoot bolt guide at backset	53

Narrow frame doors		
5434	Mortise Lock with transmission bar	56
5834	Mortise Lock with transmission bar, medium version	56
5630	Mortise Lock with roller-latch	57
5530	Mortise Deadlock	57

Refurbishment		
Solid leaf doors (Wooden & Steel doors) CES vario		
0701	Renovation lock-body with shortened lock case (153 mm)	62
0702	Renovation lock-body with shortened lock case (153 mm)	62
0705	Industrial-building lock-body according to DIN 18251-1	62
0706	Industrial-building lock-body according to DIN 18251-1	62
0720	Sashlock	60
0721	Bathroom-Lock	60
0722	Latch-Lock	60
0723	Nightlatch-Lock	60
0724PZ	Deadlock	60
0724WC	Deadlock	60
0725	Fitting forend for Sashlock	60
0726	Fitting forend for Bathroom-Lock	60
0727	Fitting forend for Latch-Lock	60
0728	Fitting forend for Nightlatch-Lock	60
0729PZ	Fitting forend for Deadlock	60
0729WC	Fitting forend for Deadlock	60
0731	Fitting forend according to DIN 18251-1	63
0732	Fitting forend according to DIN 18251-1	63

Narrow frame doors CES vario Flex		
CVF STARTSET	CES vario Flex "Starter Set"	66
CVF PROFISSET*	CES vario Flex "Pro Set"	66
Restocking kit		66
Order form		67

Striking plates		
	Overview "Which striking plate fits which lock?"	70
0400	Angular striking plate for rebated doors	71
0402	Angular striking plate for rebated doors	71
0433	Angular striking plate for rebated doors	72
0439	Angular striking plate for rebated doors	71
0445	Angular striking plate for rebated doors	73
0504	Flat striking plate for flush doors	73
0504-11	Flat striking plate for flush doors	73
0504-16	Flat striking plate for flush doors	73
0507	Striking plate	74
0508	Striking plate	74
0510	Striking plate	75
0511	Striking plate	75
0512	Striking plate	76
0513	Striking plate	76
0514	Striking plate	76
0518	Flat striking plate for flush doors	72
0522	Flat striking plate for flush doors	77
0522-16	Flat striking plate for flush doors	77
0522-17	Flat striking plate for flush doors	77
0522-18	Flat striking plate for flush doors	77
0590	Flat striking plate	77
2524	Striking plate	56
5729	Striking plate	56
5730	Striking plate	57



About CES

Made in Germany – made by CES

Safety and quality made in Germany – this is what the locking and access control systems produced by C.Ed. Schulte GmbH, known internationally as CES, stand for. The family-run business was founded in Velbert, near Düsseldorf, Germany, in 1840. And here, at the heart of German lock and security technology manufacturing, CES product developers and engineers today are still working towards continuously improving locks and locking solutions, and thus meeting the challenges of the digital world. The Federal Chancellery in Berlin, the Elbphilharmonie concert halls in Hamburg, the airport in Ankara and the Burj Khalifa in Dubai – CES expertise is in all of these buildings.

A lock for every need

For every building there is the right lock and the right locking solution. Where there are many people with different access authorisations, the electronic locking systems made by CES are particularly suitable.

But also the highly secure mechanical CES locking systems and cylinders, which are able to realise complex locking plans, are in demand by commercial and municipal property developers.

Furthermore, the CES product range includes a selection of mortise locks for the high-end contract business, for swing or sliding doors – and for fire doors. Fire-protection locks in particular must meet the highest standards of safety and quality. CES products are certified and meet the requirements of the European standard EN 12209.

As well as safety, design also plays an important role in mortise locks. Be they matt or shiny, brass, burnished or stainless steel: the in-house electroplating plant is able to customise lock cases, forends and striking plates in line with customer requirements and adapt them to the specified design concept. The over 1,000 mortise locks in the rooms of the Armani Hotel in Burj Khalifa, for instance, were delivered with coated forends and striking plates in classic Armani brown.



Certificates & Product Declaration

Quality & energy management

Customer satisfaction, customer focus, process efficiency and the ability to react quickly and flexibly to market requirements are a constant concern for CES.

As acknowledged proof of competence and efficiency, CES is certified to the strict specifications of DIN EN ISO 9001

In addition, CES provides a certified energy management system according to DIN EN ISO 50001 as an active contribution to the protection of the environment and to reduce CO₂ emissions.

Environmental product declaration

The sustainable use of resources is an important management task for CES. The Environmental Product Declaration (EPD) according to ISO 14025 and EN 15804 refers to mechanical mortise locks intended for installation in door systems made of different materials and for various applications. The certificate contains quantitative environmental information from the life cycle of a mortise lock. The EPD is available for download on the CES website.

Our certified products

With the locks for single-leaf fire doors, CES presents high-quality lock solutions for the demanding contract business. In addition to certification by the MPA in Dortmund in accordance with the DIN EN 12209 and EN 179 standards, the new lock range also has the Warrington "certifire" certificate of approval.

The fire tests with the highest demands for fire resistance were successfully passed. Therefore the fire rated locks are perfectly suitable for wooden doors up to 120 minutes and for steel doors up to 240 minutes. The highest quality fire-resistant lock in the series combines all functions, such as noise damping, frame-friendly closing, locking latch bolt, as well as panic function E.



Features

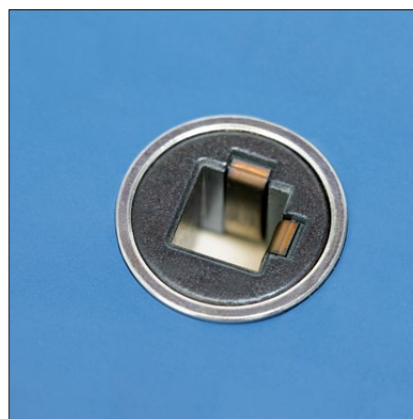
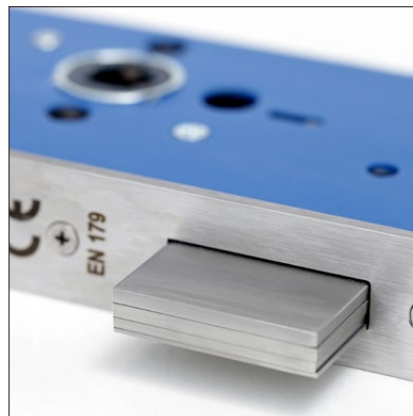

Anti-thrust latch
as mechanical latch blocking mechanism,
effective up to a door gap of 5.0 mm

Sound absorbing materials
are standard, in the interior, so these
locks stand out by their particularly si-
lent latching

Massive dead-bolt
nickel plated, for panic locks in single-turn
design with 20 mm throw

Bushed TENAX clamp follower
with Leaf springs inside which locate the
spindle and ensure its perfect fit

Made in Germany
Forend stainless steel 1.4301/ AISI 304
High-alloy chrome nickel steel

Escape lock with function E
including antiblocking function which
allows combination with knob cylinders

Our product highlights

Triple latch

When the latch hits the striking plate during the closing process, the crank pushes the latch into the lock. As a result, the impact noise is reduced and the door quietly falls shut.



Different backsets

From XS to XXL

The backset is one of the most important dimensions of door locks, since the lock must match the mortise and existing holes on your door to allow the fittings to be fitted.



up to 210 mm (see page 39)

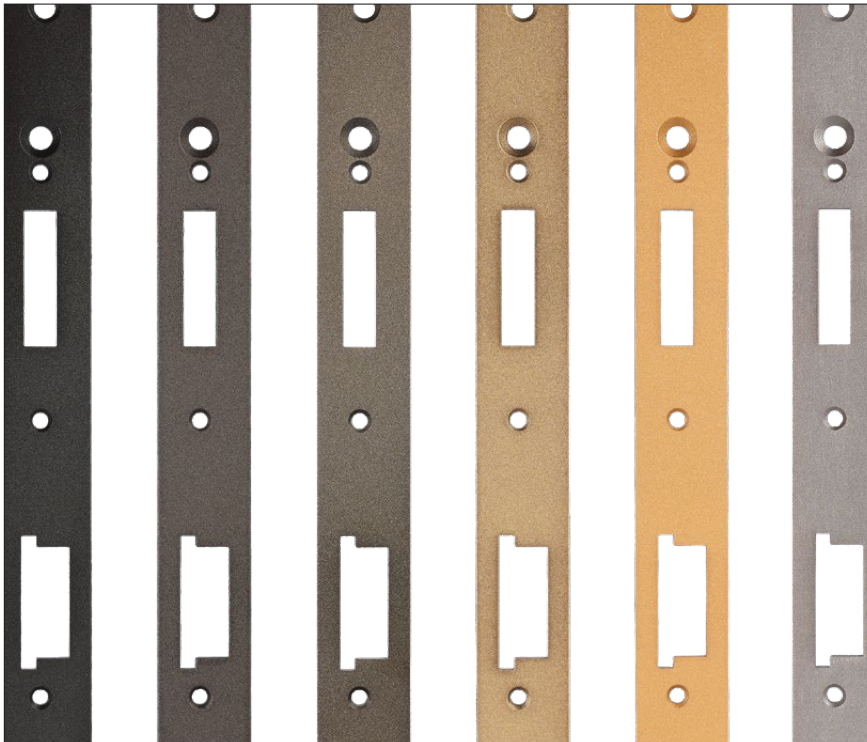

The finishing makes the difference

Thanks to its electroplating plant, CES is able to offer a wide variety of colours and finishes: satin or glossy, brass, burnished, stainless steel, white...

Sometimes, the critical fact for receiving an order in the contract business is that the lock adapts to the given design concept. Upon customer request, our electroplating experts finish forend and striking plate of the lock.

Get more information about our unique surfaces: <https://look-feel.ces.eu>



Our Expertise: Special Locks

Our range of special locks for your unique applications offers tailor-made solutions for every door: swing doors, sliding doors, radiation protection doors or OR doors.

Various latch-bolts and deadbolts, such as the roller latch for swing doors, the hook bolt or hook latch bolt for sliding doors, or the transmission bar guide behind the forend for OR sliding doors, reliably lock the door in this special situation.



Locks for solid leaf doors

■ for fire protection doors and escape routes

- for industrial buildings
- for swing and sliding doors
- for special doors

9100	Mortise Sashlock for single-leaf fire-rated doors	14
9100SP	Mortise Sashlock with Anti-thrust latch for single-leaf fire-rated doors	15
9100F	Mortise Nightlatch-Lock for single-leaf fire-rated doors	16
9100FL	Mortise Latch-Lock for single-leaf fire-rated doors	17
9100F-SP	Mortise Nightlatch-Lock with Anti-thrust latch for single-leaf fire-rated doors	18
9100R	Mortise Deadlock for single-leaf fire-rated doors	19
9100WC	Mortise Bathroom-Lock for single-leaf fire-rated doors	20
9100E	Mortise Escape-Lock with panic-function E for single-leaf fire-rated doors	21
9100E-SP	Mortise Escape-Lock with Anti-thrust latch for single-leaf fire-rated doors	22

9100

Mortise Sashlock for single-leaf fire-rated doors Premium Class



Features

- Prepared for euro-profile-cylinder
- With transmission bar
- Handed (left hand/right hand to be specified)
- Centre distance 72 mm, backset 55 mm (60, 65, 70 and 80 mm)
- Bushed TENAX clamp follower 8 mm, sintered steel
- Forend 24 (20) x 235 mm, flush (rebated) doors, edged or rounded, satin stainless steel 1.4301 (AISI 304)
- Lock case galvanized and blue lacquered
- Triple latch-bolt sintered steel, nickel-plated;
- (Solid) Deadbolt steel, nickel-plated, double throw (20 mm)
- Striking plate 0522-16, edged or rounded, satin stainless steel, non-handed
- Screws included

Classification

EN 12209	3X810G2BA30
CE marked	Approved product, certificate no. 0432-CPR-00292-02
Certifire	Approved product, certificate no. CF 5418
Fire safety	Successful fire test to BS EN 1634-1 Timber door 30, 60, 90 and 120 minutes Steel door 30, 60, 90, 120 and 240 minutes

Intumescent lock pack (not included in delivery)

required	For use on 60, 90, 120 minutes timber fire doors
not required	For use on 30 minutes timber fire doors and steel fire doors

More details about striking plates from page 69



Art.No. 0522-16

Art.No. 9100

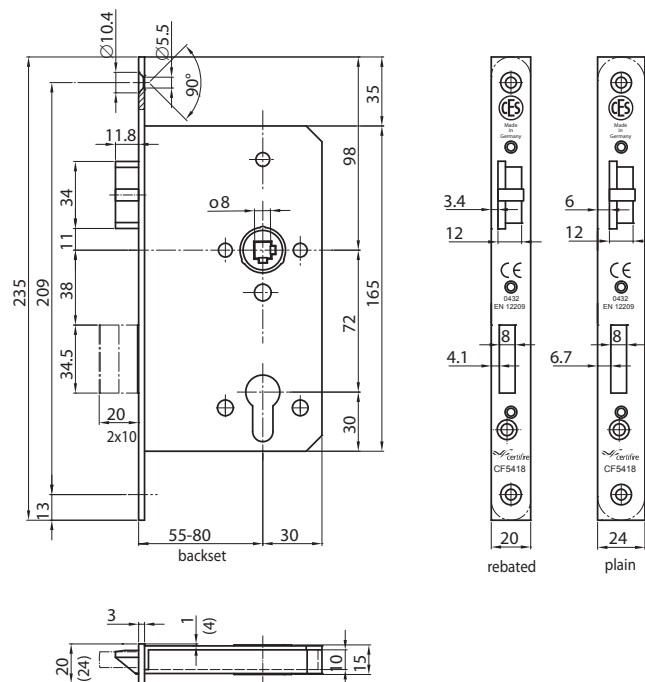

9100SP

Mortise Sashlock with Anti-thrust latch for single-leaf fire-rated doors

Premium Class



Features

- Anti-thrust latch as mechanical latch-bolt blocking mechanism
- Prepared for euro-profile-cylinder
- With transmission bar
- Handed (left hand/right hand to be specified)
- Centre distance 72 mm, backset 55 mm (60, 65, 70 and 80 mm)
- Bushed TENAX clamp follower 8 mm, sintered steel
- Forend 24 (20) x 235 mm, flush (rebated) doors, edged or rounded, satin stainless steel 1.4301 (AISI 304)
- Lock case galvanized and blue lacquered
- Triple latch-bolt sintered steel, nickel-plated
- (Solid) deadbolt steel, nickel-plated, double throw (20 mm)
- Striking plate 0522-16, edged or rounded, satin stainless steel, non-handed
- Screws included

Classification

EN 12209	3 X810G2BA30
CE marked	Approved product, certificate no. 0432-CPR-00292-02
Certifire	Approved product, certificate no. CF 5418
Fire safety	Successful fire test to BS EN 1634-1 Timber door 30, 60, 90 and 120 minutes Steel door 30, 60, 90, 120 and 240 minutes

Intumescent lock pack (not included in delivery)

required	For use on 60, 90, 120 minutes timber fire doors
not required	For use on 30 minutes timber fire doors and steel fire doors

More details about striking plates from page 69



Art.No. 0522-16

Art.No. 9100SP

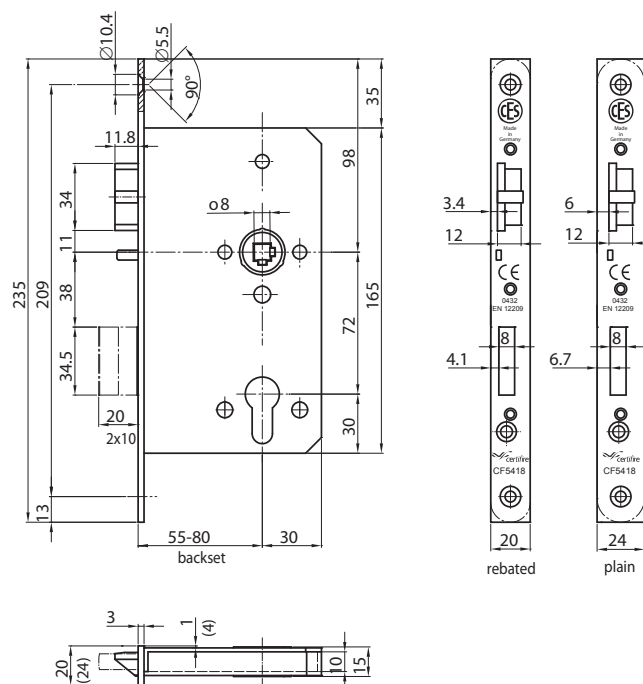

9100F

Mortise Nightlatch-Lock for single-leaf fire-rated doors Premium Class



Features

- Prepared for euro-profile-cylinder
- With transmission bar
- Handed (left hand/right hand to be specified)
- Centre distance 72 mm, backset 55 mm (60, 65, 70 and 80 mm)
- Bushed TENAX clamp follower 8 mm, sintered steel
- Forend 24 (20) x 235 mm, flush (rebated) doors, edged or rounded, satin stainless steel 1.4301 (AISI 304)
- Lock case galvanized and blue lacquered
- Triple latch-bolt sintered steel, nickel-plated;
- Striking plate 0504-16, edged or rounded, satin stainless steel
- Screws included

More details about striking plates from page 69

Classification

EN 12209	3X810G-BA30
CE marked	Approved product, certificate no. 0432-CPR-00292-02
Certifire	Approved product, certificate no. CF 5418
Fire safety	Successful fire test to BS EN 1634-1 Timber door 30, 60, 90 and 120 minutes Steel door 30, 60, 90, 120 and 240 minutes

Intumescent lock pack (not included in delivery)

required	For use on 60, 90, 120 minutes timber fire doors
not required	For use on 30 minutes timber fire doors and steel fire doors



Art.No. 0504-16



Art.No. 9100F

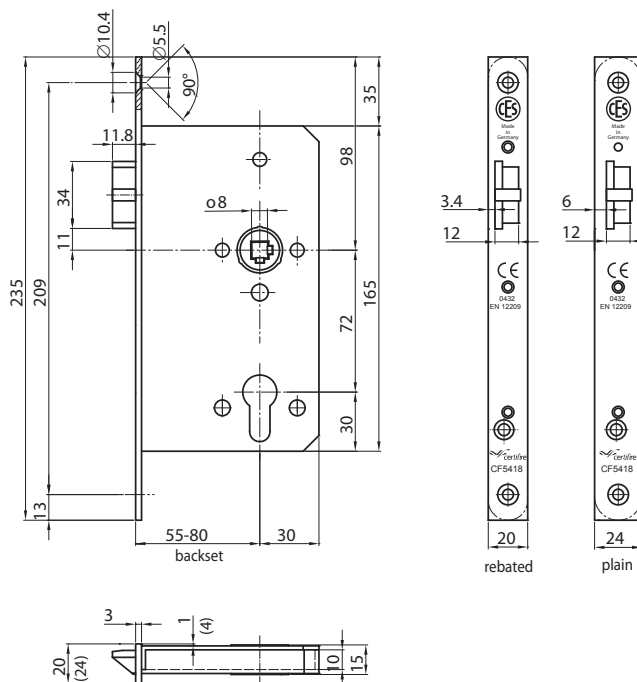

9100FL

Mortise Latch-Lock
for single-leaf fire-rated doors
Premium Class



Features

- Only handle/lever
- Handed (left hand/right hand to be specified)
- Backset 55 mm (60, 65, 70 and 80 mm)
- Bushed TENAX clamp follower 8 mm, sintered steel
- Forend 24 (20) x 235 mm, flush (rebated) doors, edged or rounded, satin stainless steel 1.4301 (AISI 304)
- Lock case galvanized and blue lacquered
- Triple latch-bolt sintered steel, nickel-plated
- Striking plate 0504-16, edged or rounded, satin stainless steel
- Screws included
- Backset 90 + 100 mm or follower 9 mm = Article number 9000FL without "certifire" certification

Classification

EN 12209	3X810G-BG30
CE marked	Approved product, certificate no. 0432-CPR-00292-02
Certifire	–
Fire safety	–

More details about striking plates from page 69



Art.No. 0504-16

Art.No. 9100FL

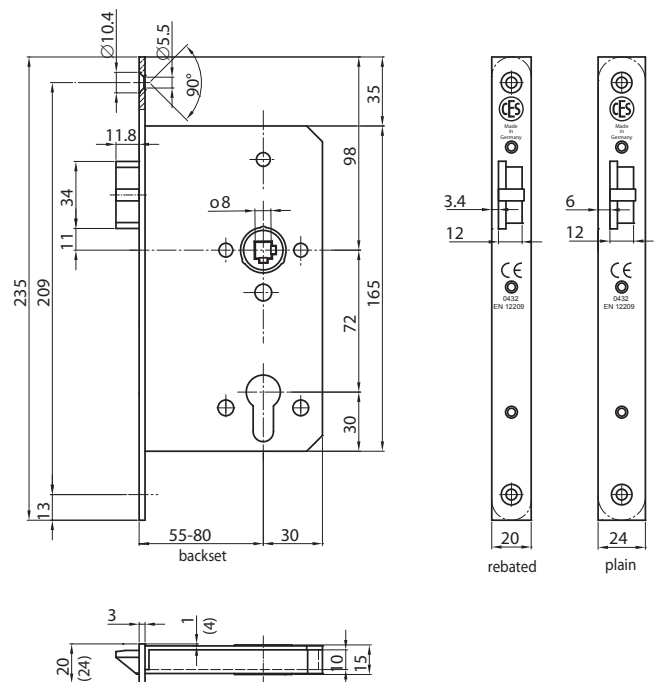

9100F-SP

Mortise Nightlatch-Lock with Anti-thrust latch for single-leaf fire-rated doors Premium Class



Features

- Anti-thrust latch as mechanical latch-bolt blocking mechanism
- Prepared for euro-profile-cylinder
- With transmission bar
- Handed (left hand/right hand to be specified)
- Centre distance 72 mm, backset 55 mm (60, 65, 70 and 80 mm)
- Bushed TENAX clamp follower 8 mm, sintered steel
- Forend 24 (20) x 235 mm, flush (rebated) doors, edged or rounded, satin stainless steel 1.4301 (AISI 304)
- Lock case galvanized and blue lacquered
- Triple latch-bolt sintered steel, nickel-plated
- Striking plate 0504-16, edged or rounded, satin stainless steel, non-handed
- Screws included

Classification

EN 12209	3X810G2BA30
CE marked	Approved product, certificate no. 0432-CPR-00292-02
Certifire	Approved product, certificate no. CF 5418
Fire safety	Successful fire test to BS EN 1634-1 Timber door 30, 60, 90 and 120 minutes Steel door 30, 60, 90, 120 and 240 minutes

Intumescent lock pack (not included in delivery)

required	For use on 60, 90, 120 minutes timber fire doors
not required	For use on 30 minutes timber fire doors and steel fire doors

More details about striking plates from page 69



Art.No. 0504-16



Art.No. 9100F-SP

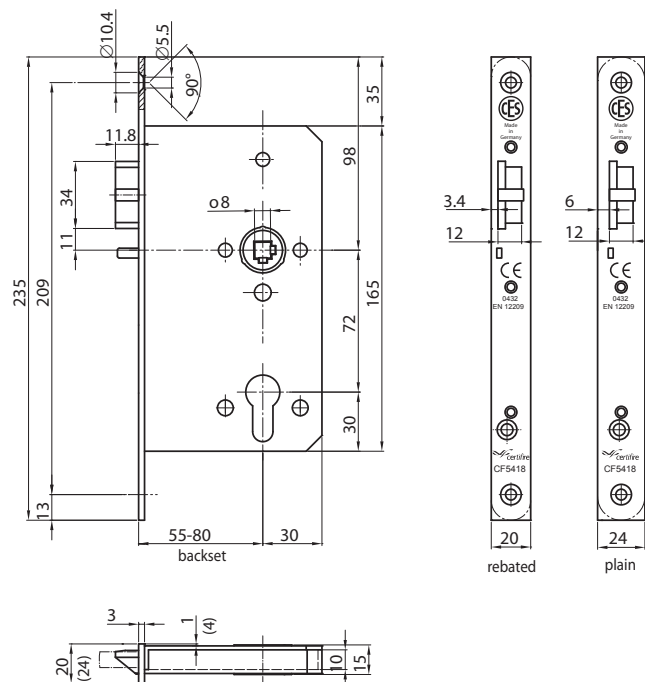

Mortise Deadlock for single-leaf fire-rated doors Premium Class



Features

- Prepared for euro-profile-cylinder
- Handed (left hand/right hand to be specified)
- Centre distance 72 mm, backset 55 mm (60, 65, 70 and 80 mm)
- Forend 24 (20) x 235 mm, flush (rebated) doors, edged or rounded, satin stainless steel 1.4301 (AISI 304)
- Lock case galvanized and blue lacquered
- (Solid) Deadbolt steel, nickel-plated, double throw (20 mm)
- Striking plate 0508, edged or rounded, satin stainless steel, non-handed
- Screws included

More details about striking plates from page 69

Classification

EN 12209	3X810G2BA00
CE marked	Approved product, certificate no. 0432-CPR-00292-02
Certifire	Approved product, certificate no. CF 5418
Fire safety	Successful fire test to BS EN 1634-1 Timber door 30, 60, 90 and 120 minutes Steel door 30, 60, 90, 120 and 240 minutes

Intumescent lock pack (not included in delivery)

required	For use on 60, 90, 120 minutes timber fire doors
not required	For use on 30 minutes timber fire doors and steel fire doors



Art.No. 0508

Art.No. 9100R

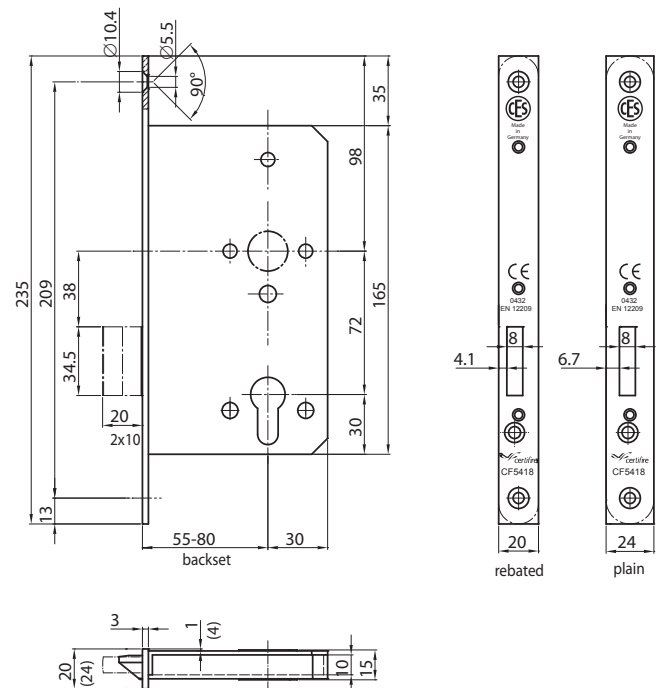

9100WC

Mortise Bathroom-Lock for single-leaf fire-rated doors Premium Class



Features

- Handed (left hand/right hand to be specified)
- Centre distance 78 mm, backset 55 mm (60, 65, 70 and 80 mm)
- Bushed TENAX clamp follower 8 mm, sintered steel
- Bathroom follower 8 mm, sintered steel
- Forend 24 (20) x 235 mm, flush (rebated) doors, edged or rounded, satin stainless steel 1.4301 (AISI 304)
- Lock case galvanized and blue lacquered
- Triple latch-bolt sintered steel, nickel-plated
- (Solid) Deadbolt steel, nickel-plated, single throw (15 mm)
- Striking plate 0522-16, edged or rounded, satin stainless steel, non-handed
- Screws included

Classification

EN 12209	3X810G2BA30
CE marked	Approved product, certificate no. 0432-CPR-00292-02
Certifire	Approved product, certificate no. CF 5418
Fire safety	Successful fire test to BS EN 1634-1 Timber door 30, 60, 90 and 120 minutes Steel door 30, 60, 90, 120 and 240 minutes

Intumescent lock pack (not included in delivery)

required	For use on 60, 90, 120 minutes timber fire doors
not required	For use on 30 minutes timber fire doors and steel fire doors

More details about striking plates from page 69



Art.No. 0522-16

Art.No. 9100WC

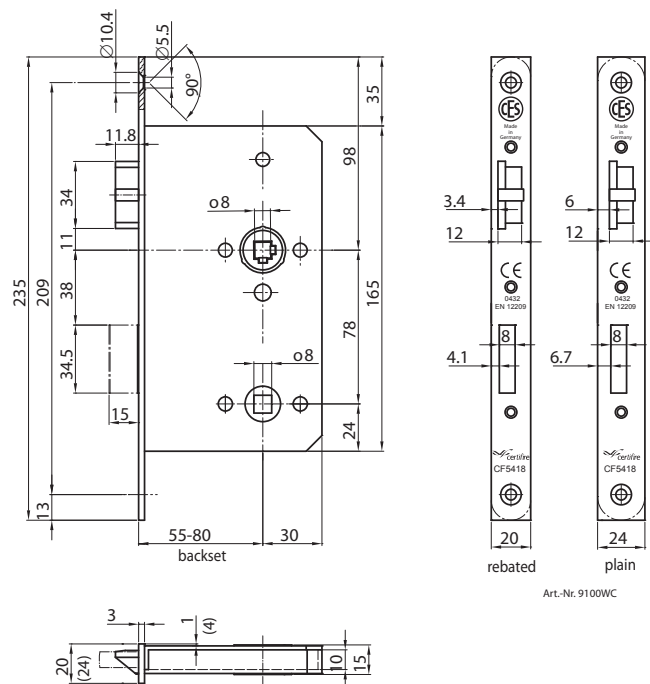

9100E

Mortise Escape-Lock with panic-function E for single-leaf fire-rated doors Premium Class



Features

- Anti-Panic-function "E"
- Prepared for euro-profile-cylinder
- With transmission bar
- Handed (left hand/right hand to be specified)
- Centre distance 72 mm, backset 55 mm (60, 65, 70 and 80 mm)
- Bushed TENAX clamp follower 8 mm, sintered steel
- Forend 24 (20) x 235 mm, flush (rebated) doors, edged or rounded, satin stainless steel 1.4301 (AISI 304)
- Lock case galvanized and blue lacquered
- Triple latch-bolt sintered steel, nickel-plated
- Solid deadbolt steel, nickel-plated, single throw (20 mm)
- Striking plate 0522-16, edged or rounded, satin stainless steel, non-handed
- Screws included

Classification

EN 179	377B1352AB
EN 12209	3X810G2BA30
CE marked	Approved product, certificate no. 0432-CPR-00292-01, 0432-CPR-00292-02
Certifire	Approved product, certificate no. CF 5418
Fire safety	Successful fire test to BS EN 1634-1 Timber door 30, 60, 90 and 120 minutes Steel door 30, 60, 90, 120 and 240 minutes

Intumescent lock pack (not included in delivery)

required	For use on 60, 90, 120 minutes timber fire doors
not required	For use on 30 minutes timber fire doors and steel fire doors

More details about striking plates from page 69



Art.No. 0522-16

Art.No. 9100E

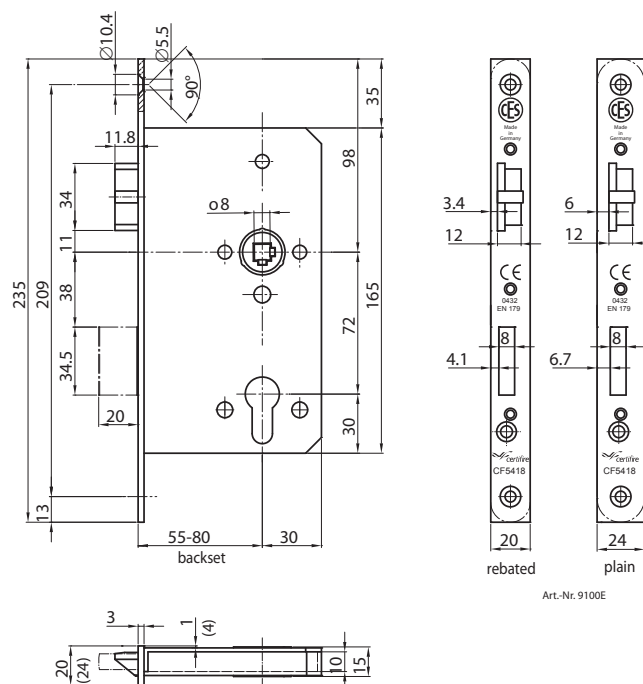

Art.-Nr. 9100E

**Mortise Escape-Lock with Anti-thrust latch
for single-leaf fire-rated doors
Premium Class**



- Anti-Panic-function “E”
- Anti-thrust latch as mechanical latch-bolt blocking mechanism
- Prepared for euro-profile-cylinder
- With transmission bar
- Handed (left hand/right hand to be specified)
- Centre distance 72 mm, backset 55 mm (60, 65, 70 and 80 mm)
- Bushed TENAX clamp follower 8 mm, sintered steel
- Forend 24 (20) x 235 mm, flush (rebated) doors, edged or rounded, satin stainless steel 1.4301 (AISI 304)
- Lock case galvanized and blue lacquered
- Triple latch-bolt sintered steel, nickel-plated
- Solid deadbolt steel, nickel-plated, single throw (20 mm)
- Striking plate 0522-16, edged or rounded, satin stainless steel, non-handed
- Screws included

EN 179	377B1352AB
EN 12209	3X810G2BA30
CE marked	Approved product, certificate no. 0432-CPR-00292-01, 0432-CPR-00292-02
Certifire	Approved product, certificate no. CF 5418
Fire safety	Successful fire test to BS EN 1634-1 Timber door 30, 60, 90 and 120 minutes Steel door 30, 60, 90, 120 and 240 minutes

required	For use on 60, 90, 120 minutes timber fire doors
not required	For use on 30 minutes timber fire doors and steel fire doors

Art.No. 9100E-SP

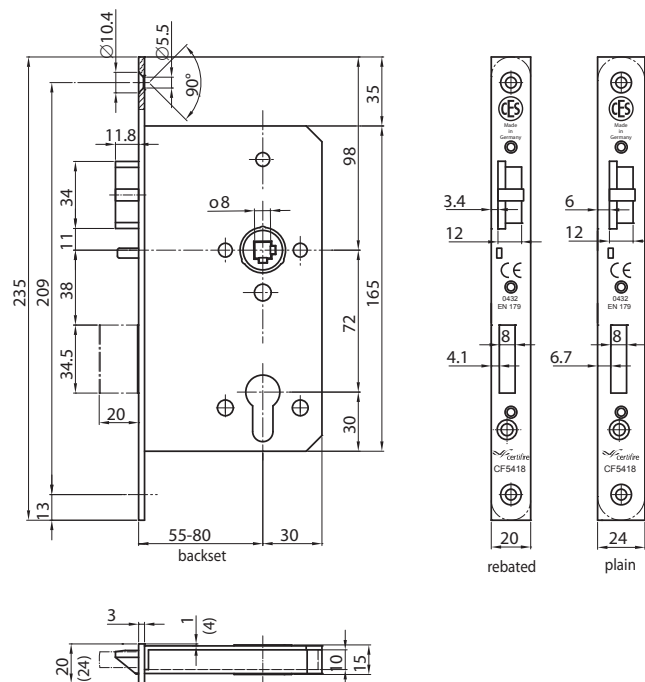

Handwriting practice lines consisting of 20 horizontal dotted lines.



Locks for solid leaf doors

- for fire protection doors and escape routes
- **for industrial buildings**
- for swing and sliding doors
- for special doors

7734	Mortise Lock with transmission bar, medium version (fixed forend)	30
7790	Mortise Bathroom-Lock , medium version (fixed forend)	31
7700-01	Mortise Latch-Lock, medium version (fixed forend)	32
7730-02	Mortise Deadlock, medium version (fixed forend)	33
7734-01	Mortise Nightlatch-Lock with transmission bar, medium version (fixed forend)	32
77.34	Mortise Lock with transmission bar and screwed forend on lockcase	34
9034	Mortise Lock with transmission bar, heavy duty version	35
9090	Mortise Bathroom-Lock , heavy duty version	35
334	DIN Contract business Sashlock	36
390	DIN Contract business Bathroom-Lock	36
334SL	DIN Contract business Sashlock with bushed follower	36
390SL	DIN Contract business Bathroom-Lock with bushed follower	36
300-01	DIN Contract business Latch-Lock	37
300-01SL	DIN Contract business Latch-Lock with bushed follower	37
2500	Mortise Latch-Lock with small lock case	38
2730	Mortise Deadlock with small lock case	39
2700	Mortise Bathroom-Lock with small lock case	39

Mortise Lock with transmission bar, medium version (fixed forend)



available backsets:	45/55/60/65/70/80 mm
distance:	72 mm
follower:	8 mm
forend:	24x235 mm edged or rounded
forend and striking plate:	steel lacquered, brass colour steel lacquered, silver colour stainless steel solid brass, polished
latch bolt:	reversible, metal nickel plated
dead bolt:	metal nickel plated

German standard according to DIN 18251-1, class 3

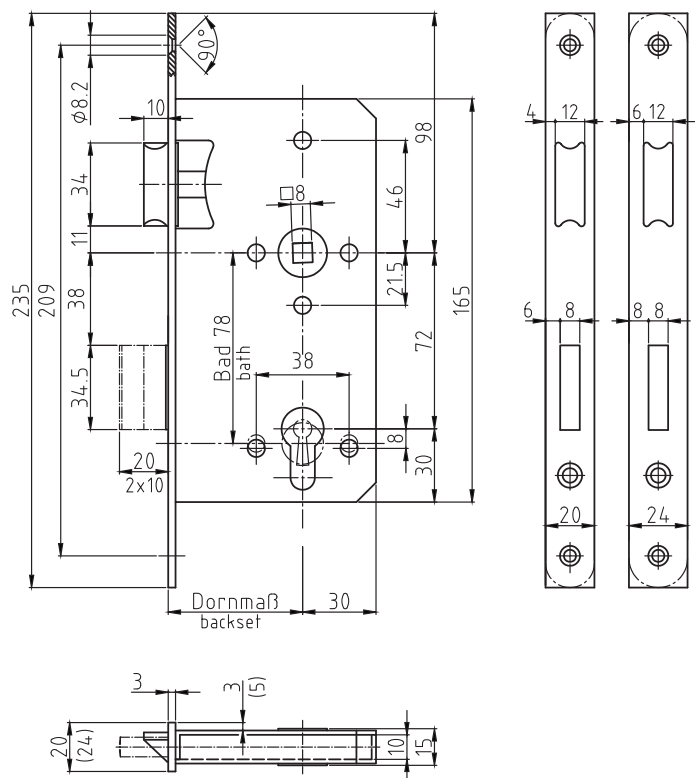

Art.No. 7734

7790

Mortise Bathroom-Lock, medium version (fixed forend)



Features

available backsets:	45/55/60/65/70/80 mm
distance:	78 mm
follower:	8 mm
forend:	24x235 mm edged or rounded
forend and striking plate:	steel lacquered, brass colour steel lacquered, silver colour stainless steel solid brass, polished
latch bolt:	reversible, metal nickel plated
dead bolt:	metal nickel plated

Classification

German standard	according to DIN 18251-1, class 3
-----------------	-----------------------------------

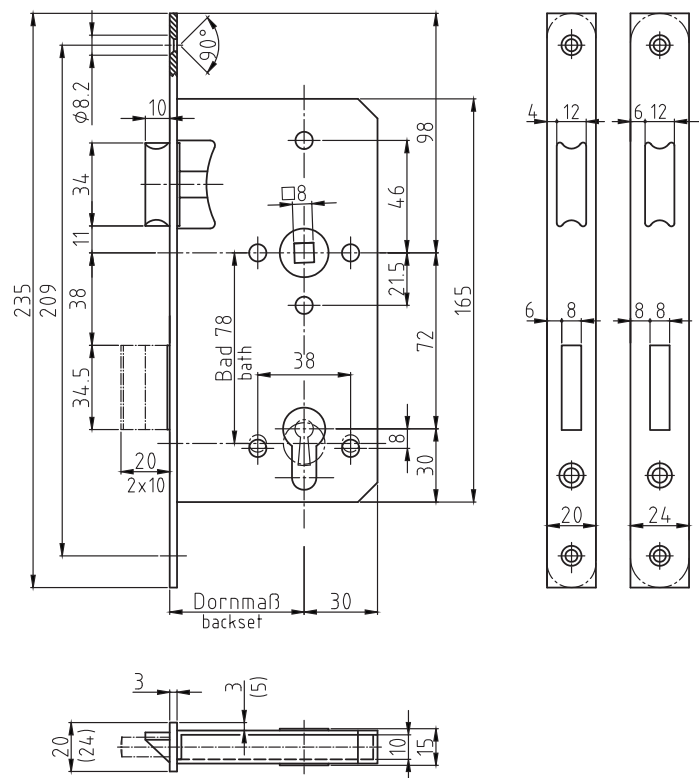

Art.No. 0522-16

Art.No. 7790

7700-01

Mortise Latch-Lock medium version (fixed forend)



Features

available backsets:	45/55/60/65/70/80 mm
follower:	8 mm
forend:	24x235 mm edged or rounded
forend and striking plate:	steel lacquered, brass colour steel lacquered, silver colour stainless steel solid brass, polished
latch bolt:	reversible, metal nickel plated

Classification

German standard	according to DIN 18251-1
-----------------	--------------------------

7734-01

Only latch bolt with transmission bar
same as 7700-01, but operated by
handle and key
72 mm distance



Art.No. 7700-01

fitting striking plate see page 77

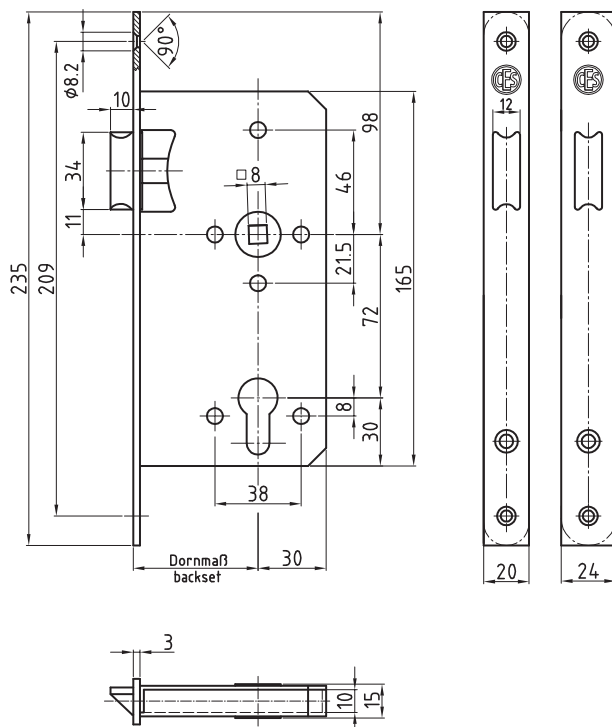

Art.No. 7734-01

7730-02

Mortise Deadlock medium version (fixed forend)



Features

available backsets:	45/55/60/65/70/80 mm
forend:	24x235 mm edged or rounded
forend and striking plate:	steel lacquered, brass colour steel lacquered, silver colour stainless steel solid brass, polished
dead bolt:	metal nickel plated

Classification

German standard	according to DIN 18251-1
-----------------	--------------------------



Art.No. 7730-02

fitting striking plate see page 77

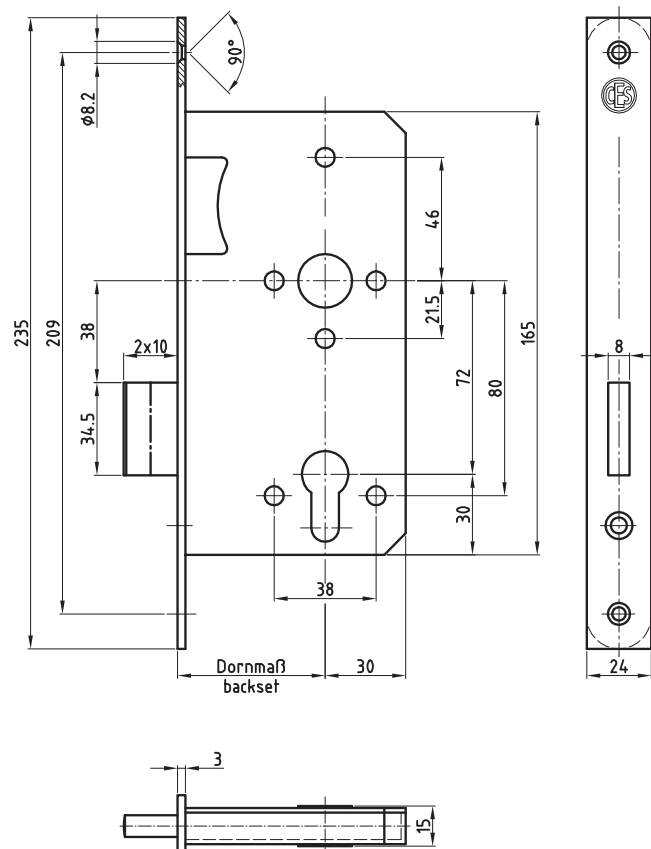

9034

Mortise Lock with transmission bar, heavy duty version



Features

available backsets:	45/55 mm
distance:	85 mm
follower:	8 mm, bushed
forend and striking plate:	stainless steel
latch bolt:	solid brass, nickel-plated
dead bolt:	solid brass, nickel-plated
forend and striking plate:	solid brass, polished
dead bolt:	solid brass, polished
latch bolt:	reversible, solid brass, polished

Also available

9090 Mortise Bathroom-Lock, heavy duty version



Art.No. 0590

Art.No. 9034

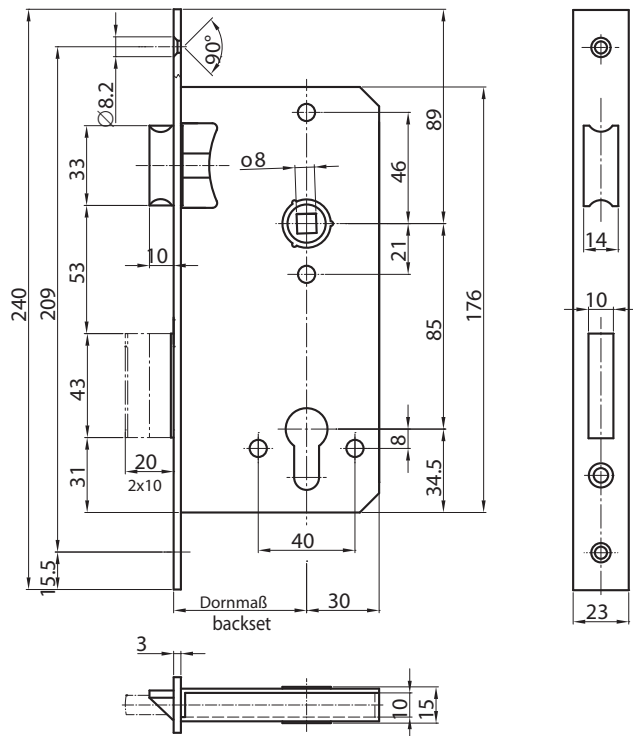

DIN Contract business Locks

Type	Description/features	Special features
334	DIN Contract business Sashlock according to DIN 18251-1, class 3 prepared for profile cylinder, with transmission bar, backset 55 (60) mm, centre distance 72 mm, 8 mm FIX follower, forend 20 x 235 mm for rebated doors or 24 x 235 mm for flush doors, edged or rounded, satin stainless steel, steel latch bolt and steel dead bolt, nickel-plated	Backset 65 mm 70 mm 80 mm
390	DIN Contract business Bathroom-Lock according to DIN 18251-1, class 3 for toilet/bathroom use with 8 mm dead-bolt follower backset 55 (60) mm, centre distance 78 mm, 8 mm FIX follower, forend 20 x 235 mm for rebated doors or 24 x 235 mm for flush doors, edged or rounded, satin stainless steel, steel latch bolt and steel dead bolt (single-turn 15 mm), nickel-plated	Special equipment 9 mm FIX follower Triple latch Noise reduction Extra lever key
334SL	DIN Contract business Sashlock with bushed follower other features like article number 334	Forend surfaces Stainless steel, polished Brass, polished Other finishes
390SL	DIN Contract business Bathroom-Lock with bushed follower other features like article number 390	Striking plates 0400 – Angular striking plate for rebated doors, Satin stainless steel 0522 – Flat striking plate for flush doors, Satin stainless steel Other designs



Art.No. 334

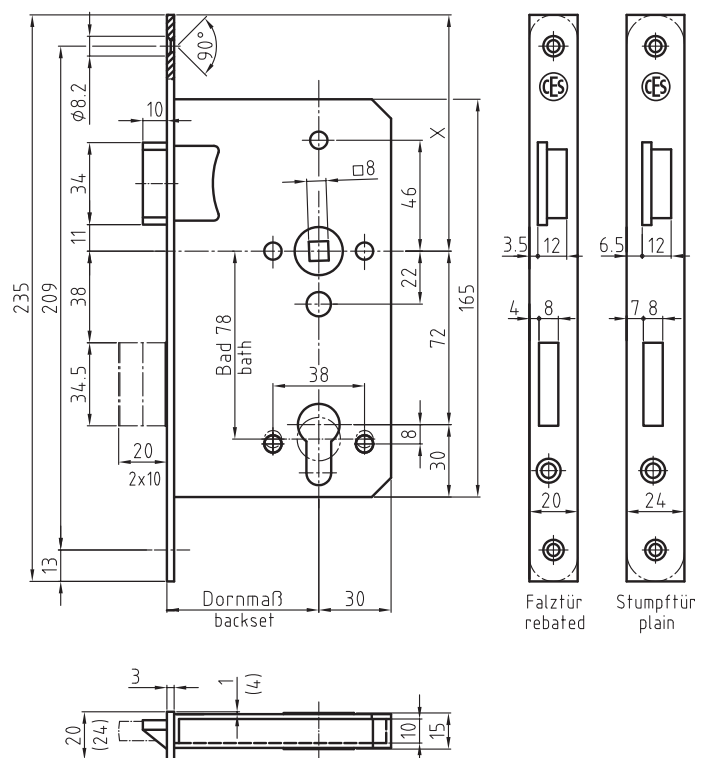

DIN Contract business Latch-Locks (with large lock case)

Type	Description/features	Special features
300-01	DIN Contract business Latch-Lock with large lock case performance values and dimensions according to DIN 18251-1, class 3 prepared for handle function only, backset 55 (60) mm, 8 mm FIX follower, forend 20 x 235 mm for rebated doors or 24 x 235 mm for flush doors, edged or rounded, satin stainless steel, steel latch bolt, nickel-plated	Backset 65 mm 70 mm 80 mm
300-01SL	DIN Contract business Latch-Lock with bushed follower and large lock case other features like article number 300-01	Special equipment Triple latch Noise reduction 9 mm FIX follower
		Forend surfaces Stainless steel, polished Brass, polished Other finishes
		Striking plates 0445 – Angular striking plate for rebated doors Satin stainless steel 0504 – Flat striking plate for flush doors Satin stainless steel Other designs

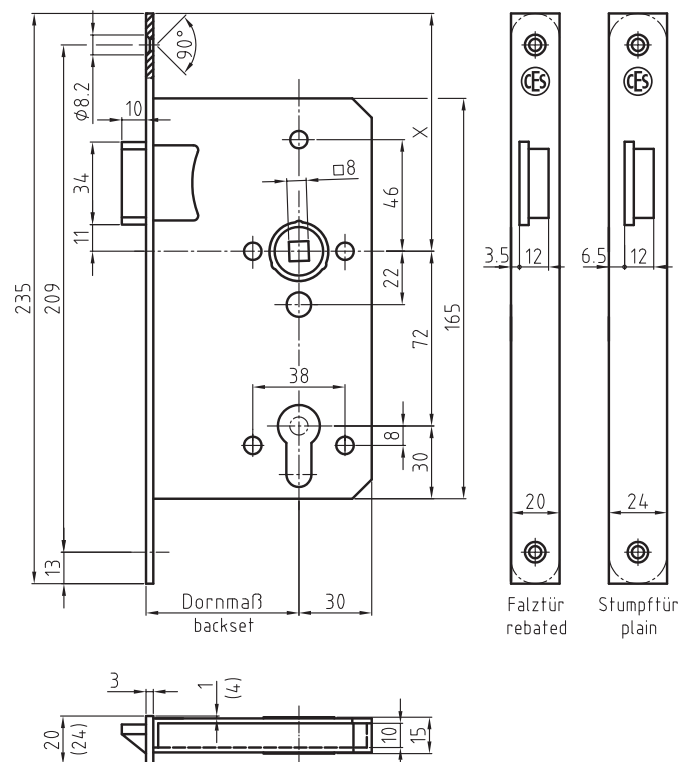

Art.No. 300-01

Art.No. 300-01SL

**Mortise Latch-Lock
with small lock case
including striking plate**

Type	Description/features	Special features
2500	Latch-Lock with small lock case prepared for handle function only, backset 55 mm, 8 mm follower, forend 20 x 185 mm for rebated doors or 24 x 185 mm for flush doors, edged or rounded, satin stainless steel, steel latch, nickel-plated including: 0445 – Angular striking plate for rebated doors or 0504 – Flat striking plate for flush doors	Backset
		60, 65 mm
		70, 80 mm
		90, 100 mm (article no. 25.00)
		110, 120 mm (article no. 25.00)
		Special equipment
		Triple latch
		Noise reduction
		9 mm follower
		Forend + striking plate
Stainless steel, polished		
Brass, polished		
Other finishes		

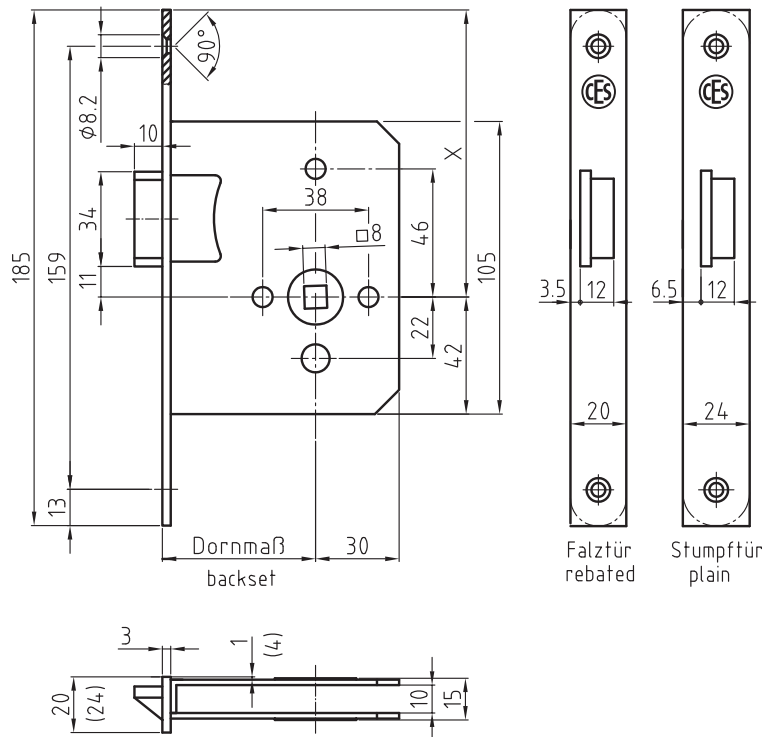

Art.No. 2500

Mortise Deadlock with small lock case including striking plate

Type	Description/features	Special features
2730	Mortise Deadlock with small lock case prepared for profile cylinder, backset 55 mm, forend 20 x 145 mm for rebated doors or 24 x 145 mm for flush doors, edged or rounded, satin stainless steel, steel dead bolt, nickel-plated including: 0507 – Striking plate for rebated doors or 0508 – Striking plate for flush doors	Backset 60, 65 mm 70, 80 mm 90, 100 mm (article no. 27.30) 110 – 150 mm (article no. 27.30) 160 – 210 mm (article no. 27.30)
2700	Mortise Deadlock with small lock case for toilet/bathroom use with 8 mm dead-bolt follower, backset 55 mm, forend 20 x 145 mm for rebated doors or 24 x 145 mm for flush doors, edged or rounded, satin stainless steel, steel dead bolt (single-turn 15 mm), nickel-plated including: 0507 – Striking plate for rebated doors or 0508 – Striking plate for flush doors	Forend + striking plate Stainless steel, polished Brass, polished Other finishes

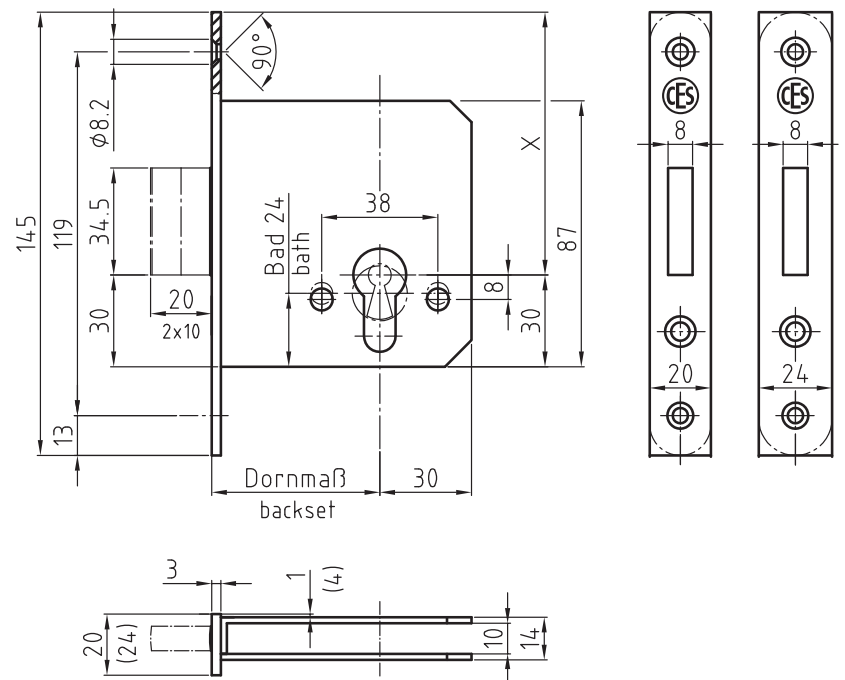

Art.No. 2730



Locks for solid leaf doors

- for fire protection doors and escape routes
- for industrial buildings
- **for swing and sliding doors**
- for special doors

4530	Swing-door Lock with roller-latch with large lock case	42
4590	Swing-door Lock with roller-latch with large lock case	42
4700	Swing-door Lock with roller-latch with small lock case	43
4730	Swing-door Lock with roller-latch with small lock case	44
4790	Swing-door Lock with roller-latch with small lock case	44
5530N	Sliding-door Lock with compass-bolt	45
5590	Sliding-door Lock with compass-bolt	45
5830	Sliding-door Lock with hook-latch	46
5800	Sliding-door Lock with hook-latch	46

Swing-door Lock with roller-latch with large lock case including striking plate

Type	Description/features	Special features
4530	Swing-door Lock with roller-latch with fitting dimensions according to DIN 18251-1 prepared for profile cylinder, backset 55 mm, forend 20 (24) x 235 mm for flush doors, edged or rounded, satin stainless steel, steel roller-latch and steel dead bolt, nickel-plated, with 8 mm square (spindle) and escutcheon piercings for rotationally locked knob attachment including: 0510 – Striking plate with blind groove	Backset
		60 mm
		65 mm
		70 mm
		80 mm
Forend + striking plate	Stainless steel, polished Brass, polished Other designs	
4590	Swing-door Lock with roller-latch with fitting dimensions according to DIN 18251-1 for toilet/bathroom use with 8 mm dead-bolt follower, backset 55 mm, forend 20 (24) x 235 mm for flush doors, edged or rounded, satin stainless steel, steel roller-latch and steel dead bolt (single-turn 15 mm), nickel-plated, with 8 mm square (spindle) and escutcheon piercings for rotationally locked knob attachment including: 0510 – Striking plate with blind groove	

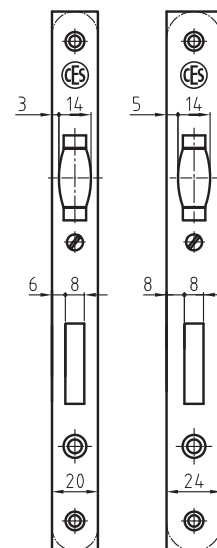
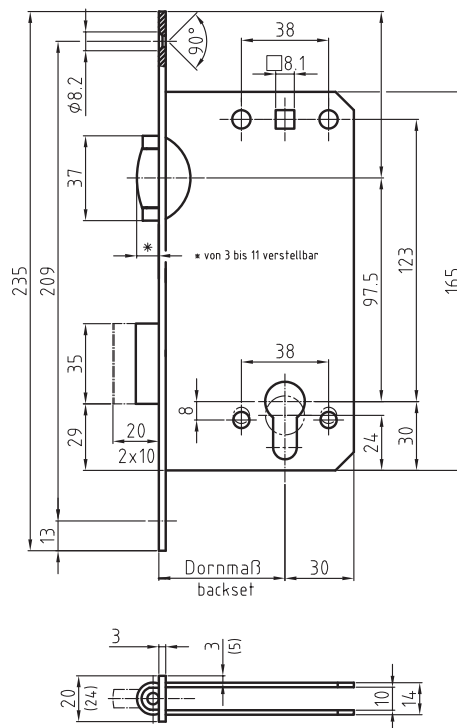

Art.No. 4530

Swing-door Lock with roller-latch with small lock case including striking plate

Type	Description/features	Special features
4700	Swing-door Lock with roller-latch with small lock case no locking function, forend 24 x 160 mm for flush doors, edged or rounded, satin stainless steel, steel roller-latch, nickel-plated including: 0511 – Striking plate with blind groove	Forend + striking plate Stainless steel, polished Brass, polished Other designs



Art.No. 4700

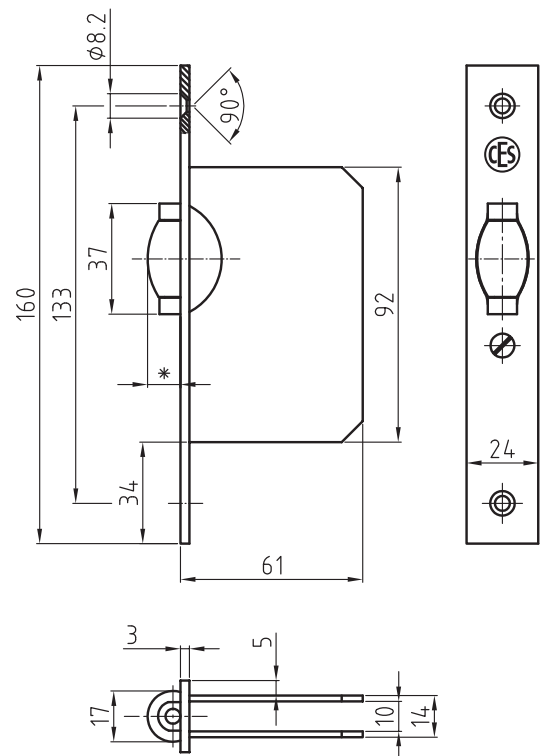

Swing-door Lock with roller-latch
with small lock case
including striking plate

Type	Description/features
4730	Swing-door Lock with roller-latch with small lock case prepared for profile cylinder, backset 55 mm, forend 24 x 145 mm for flush doors, edged or rounded, satin stainless steel, steel roller-latch, nickel-plated including: 0511 – Striking plate without blind groove
4790	Swing-door Lock with roller-latch with small lock case for toilet/bathroom use with 8 mm dead-bolt follower, backset 55 mm, forend 24 x 145 mm for flush doors, edged or rounded, satin stainless steel, steel roller-latch, nickel-plated including: 0511 – Striking plate without blind groove

Special features	
Forend + striking plate	Stainless steel, polished
	Brass, polished
	Other designs

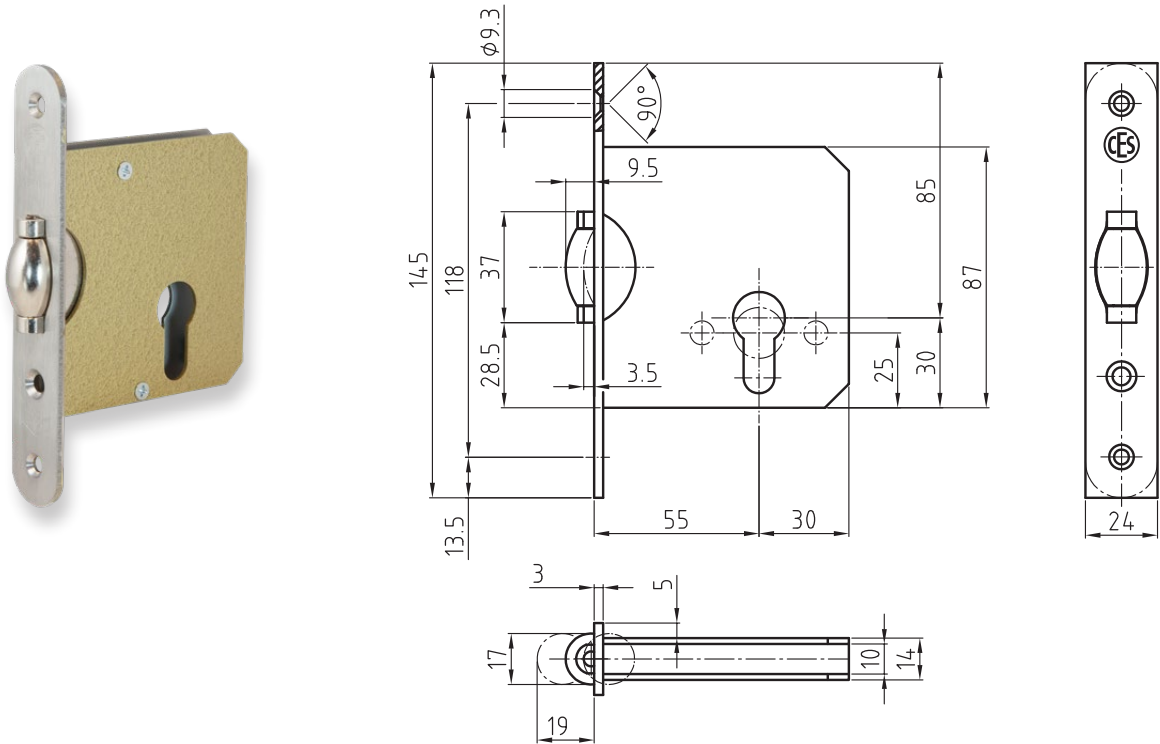

Art.No. 4730

Sliding-door Lock with compass-bolt including striking plate

Type	Description/features
5530N	Sliding-door Lock with compass-bolt prepared for profile cylinder, backset 55 mm forend 20 (22) x 150 mm for flush doors, edged or rounded, satin stainless steel, compass-bolt, steel nickel-plated including: 0512 – Striking plate
5590	Sliding-door Lock with compass-bolt for toilet/bathroom use with 8 mm dead-bolt follower, backset 55 mm, forend 20 (22) x 150 mm for flush doors, edged or rounded, satin stainless steel, compass-bolt, steel nickel-plated including: 0512 – Striking plate

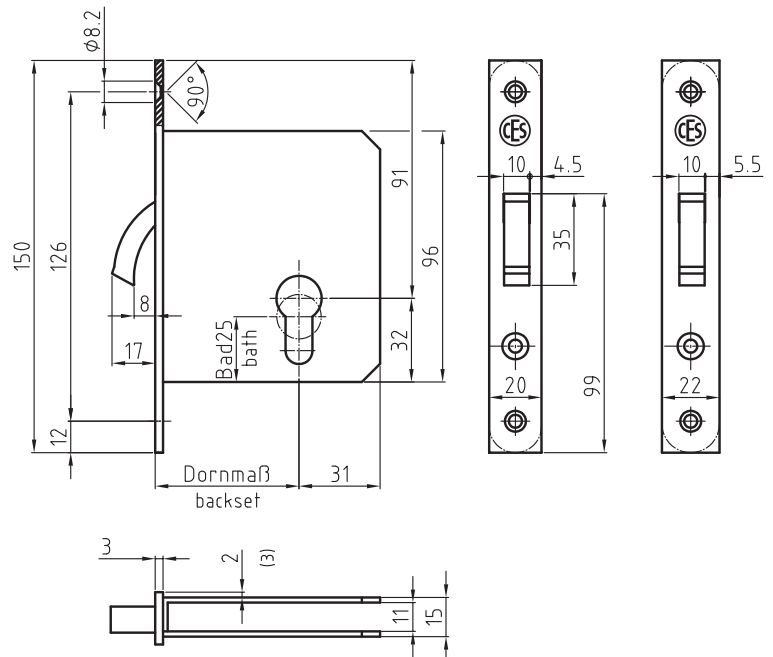

Art.No. 5530N

Sliding-door Lock with hook-latch including striking plate

Type	Description/features	Special features
5830	Sliding-door Lock with hook-latch (not lockable) prepared for profile cylinder, backset 55 mm, forend 20 (22) x 168 mm for flush doors, edged or rounded, satin stainless steel, hook-latch steel, nickel-plated including: 0514 – Striking plate	Forend + striking plate Stainless steel, polished Brass, polished Other designs
5800	Sliding-door Lock with hook-latch (not lockable) for toilet/bathroom use with 8 mm escutcheon follower, backset 55 mm forend 20 (22) x 168 mm for flush doors, edged or rounded, satin stainless steel, hook-latch steel, nickel-plated including: 0514 – Striking plate	

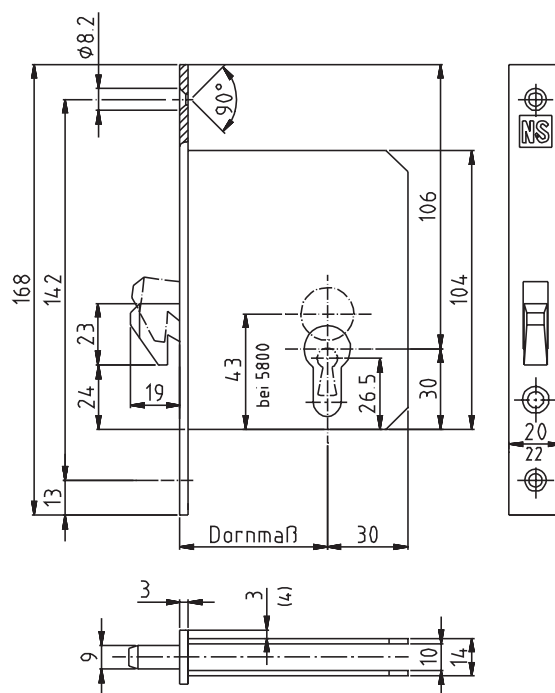

Art.No. 5830

Handwriting practice lines consisting of 20 horizontal dotted lines.



Locks for solid leaf doors

- for fire protection doors and escape routes
- for industrial buildings
- for swing and sliding doors
- **for special doors**

Special Mortise Locks with 3 bolts		
8030	Special Mortise Lock without transmission bar	51
8034	Special Mortise Lock with transmission bar	51
Radiation shielding doors		
8230	Mortise Lock without transmission bar	52
8234	Mortise Lock with transmission bar	52
Sliding door Locks for operating theatres		
9003	Sliding door Lock with shoot bolt guide behind the forend	53
9004	Sliding door Lock with shoot bolt guide at backset	53
9005	Sliding door Lock with shoot bolt guide behind the forend	53
9006	Sliding door Lock with shoot bolt guide at backset	53

Blank lined area for writing.

Special Mortise Locks with 3 bolts

Type	Description/features	Special features
8030	Special Mortise Lock with 3 bolts prepared for profile cylinder, without transmission bar, with bathroom locking via 8 mm dead bolt follower, backset 55 (60) mm, centre distance 72 und 135 mm, 8 mm follower, forend 20 x 295 mm for rebated doors or 24 x 295 mm for flush doors, edged or rounded, satin stainless steel, steel latch bolt and steel dead bolt, nickel-plated	Backset
		65 mm
		70 mm
		80 mm
		Special equipment
		Emergency function
8034	Special Mortise Lock with 3 bolts prepared for profile cylinder, with transmission bar, with bathroom locking via 8 mm dead bolt follower, backset 55 (60) mm, centre distance 72 und 135 mm, 8 mm follower, forend 20 x 295 mm for rebated doors or 24 x 295 mm for flush doors, edged or rounded, satin stainless steel, steel latch bolt and steel dead bolt, nickel-plated	Forend surfaces
		Stainless steel, polished
		Brass, polished
		Other designs
		Striking plates
		0433 – Angular striking plate for rebated doors, Satin stainless steel
		0518 – Flat striking plate for flush doors, Satin stainless steel

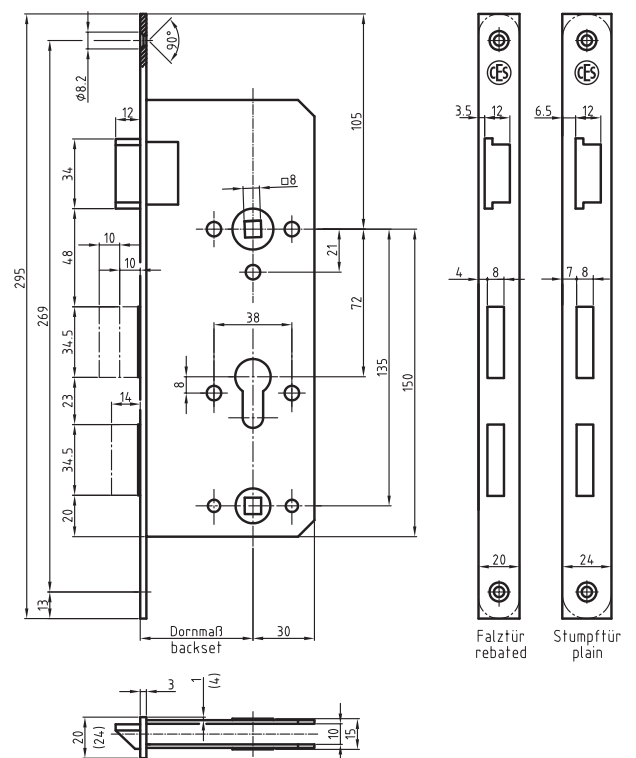

Art.No. 0518

Art.No. 8030

Mortise Locks for sliding doors of operating theatres

Type	Description/features
9003	Mortise lock for operating theatres with shoot bolt guide behind the forend, with M10 (M8) stud bolt to receive the shoot bolt, prepared for profile cylinder, backset 45 mm, forend 24 x 205 mm for flush doors, edged or rounded, satin stainless steel
9004	Mortise lock for operating theatres with shoot bolt guide at backset, backset 45 (50, 55, 60, 65, 70, 80, 90, 100) other features same as article no. 9003
9005	Mortise lock for operating theatres with shoot bolt guide behind the forend, with M10 (M8) stud bolt to receive the shoot bolt, for toilet/bathroom use with 8 mm escutcheon follower, backset 45 mm, forend 24 x 205 mm for flush doors, edged or rounded, satin stainless steel
9006	Mortise lock for operating theatres with shoot bolt guide at backset, backset 45 (50, 55, 60, 65, 70, 80, 90, 100) other features same as article no. 9005

Special features	
Foreend	15 mm, edged, Zinc-plated (electroplated)
	18 mm, edged, Satin stainless steel
	20 mm, edged, Satin stainless steel
Accessories	Round bar, up to 1,500 mm (article no. 0601), Zinc-plated (electroplated)
	Round bar, as from 1,501 mm (article no. 0601), Zinc-plated (electroplated)
	Bar guiding plate (article no. 0604), Zinc-plated (electroplated)
	Covering rail (article no. 0602/0603), Satin stainless steel
	Other designs



Art.No. 9003

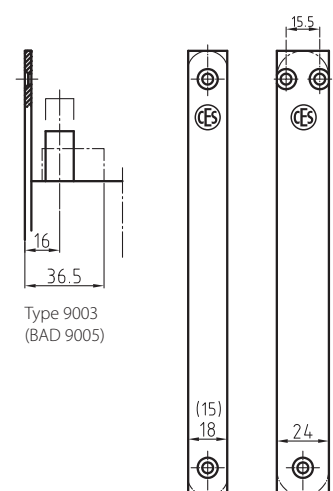
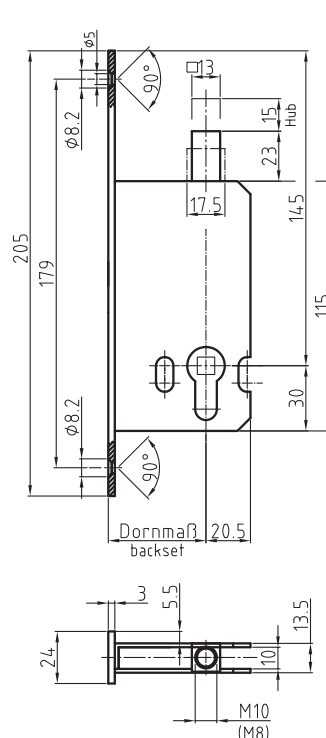



Locks for narrow frame doors

5434	Mortise Lock with transmission bar	56
5834	Mortise Lock with transmission bar, medium version	56
5630	Mortise Lock with roller-latch	57
5530	Mortise Deadlock	57

5434

Mortise Lock with transmission bar

Features	
available backsets:	25 mm one-turn, bolt space 15 mm 30/35/40/45 mm special two-turn, bolt space 25 mm
distance:	92 mm
follower:	8 mm
forend:	24x255 mm edged galvanized, silver lacquered stainless steel plastic coated
latch bolt:	steel nickel plated
dead bolt:	steel nickel plated
striking plate:	art.-no. 5729, art.-no. 2524 (6/8/10/12 mm)



Art.No. 5729 + 2524

Art.No. 5434

5834

Mortise Lock with transmission bar (medium version)

Features	
available backsets:	20, 26, 30 mm only one-turn, bolt space 15 mm
distance:	92 mm
follower:	8 mm
forend:	24x245 mm edged galvanized, silver lacquered stainless steel plastic coated
latch bolt:	steel nickel plated
dead bolt:	steel nickel plated
striking plate:	art.-no. 5729, art.-no. 2524 (6/8/10/12 mm)



Art.No. 5729 + 2524

Art.No. 5834

5630

Mortise Lock with roller-latch

Features	
available backsets:	30, 35, 45 mm special two-turn, bolt space 25 mm
forend:	24x255 mm edged galvanized, silver lacquered stainless steel, plastic coated
dead bolt:	steel nickel plated
striking plate:	art.-no. 5729, art.-no. 2524 (6/8/10/12 mm)



Art.No. 5729 + 2524

Art.No. 5630

5530

Mortise Deadlock

Features	
available backsets:	25 mm one-turn, bolt space 15 mm 25, 30, 35 mm special two-turn, bolt space 25 mm
forend:	24x160 mm edged galvanized, silver lacquered stainless steel, plastic coated
dead bolt:	steel nickel plated
striking plate:	art.-no. 5730



Art.No. 5730

Art.No. 5530



Locks for refurbishment

- **CES vario for solid leaf doors**
- CES vario Flex for narrow frame doors

0701	Renovation lock-body with shortened lock case (153 mm)	62
0702	Renovation lock-body with shortened lock case (153 mm)	62
0705	Industrial-building lock-body according to DIN 18251-1	62
0706	Industrial-building lock-body according to DIN 18251-1	62
0720	Sashlock	60
0721	Bathroom-Lock	60
0722	Latch-Lock	60
0723	Nightlatch-Lock	60
0724PZ	Deadlock	60
0724WC	Deadlock	60
0725	Fitting forend for Sashlock	60
0726	Fitting forend for Bathroom-Lock	60
0727	Fitting forend for Latch-Lock	60
0728	Fitting forend for Nightlatch-Lock	60
0729PZ	Fitting forend for Deadlock	60
0729WC	Fitting forend for Deadlock	60
0731	Fitting forend according to DIN 18251-1	63
0732	Fitting forend according to DIN 18251-1	63

CES vario for solid leaf doors

Locks with reversible latch-bolt / non-handed version

Features

- performance values and dimensions according to DIN 18251-1, class 3
- backset 55 (60, 65, 70, 80) mm, 8 mm follower
- lock case lacquered in satin blue
- steel latch bolt and steel dead bolt, nickel-plated

including:

- stainless fixing screws for fitting forends

optional:

- with light spring for knob handles
- with strong spring for heavy handles

Lock body	Description	Fitting forend for flush doors	Description	Striking plate
0720	Sashlock prepared for euro-profile cylinder, with transmission bar distance 72 mm	0725	Fitting forend for Sashlock art. no. 0720 edged or rounded, satin stainless steel, for flush doors,: 20 x 235 mm, 24 x 235 mm	0522-16
0721	Bathroom-Lock bathroom follower 8mm, distance 78 mm	0726	Fitting forend for Bathroom-Lock art. no. 0721 edged or rounded, satin stainless steel, for flush doors,: 20 x 235 mm, 24 x 235 mm	0522-16
0722	Latch-Lock only with lever	0727	Fitting forend for Latch-Lock art. no. 0722 edged or rounded, satin stainless steel, for flush doors,: 20 x 235 mm, 24 x 235 mm	0522-17
0723	Nightlatch-Lock prepared for euro-profile cylinder, with transmission bar distance 72 mm	0728	Fitting forend for Nightlatch-Lock art. no. 0723 edged or rounded, satin stainless steel, for flush doors,: 20 x 235 mm, 24 x 235 mm	0522-17
0724PZ	Deadlock prepared for euro-profile cylinder	0729PZ	Fitting forend for Deadlock art. no. 0724PZ edged or rounded, satin stainless steel, for flush doors,: 20 x 235 mm, 24 x 235 mm	0522-18
0724WC	Deadlock bathroom follower 8mm	0729WC	Fitting forend for Deadlock art. no. 0724WC edged or rounded, satin stainless steel, for flush doors,: 20 x 235 mm, 24 x 235 mm	0522-18

CES vario for solid leaf doors



Art.No.
0720



Art.No.
0721



Art.No.
0722



Art.No.
0723



Art.No.
0724PZ



Art.No.
0724WC



Art.No.
0725



Art.No.
0726



Art.No.
0727



Art.No.
0728



Art.No.
0729PZ



Art.No.
0729WC

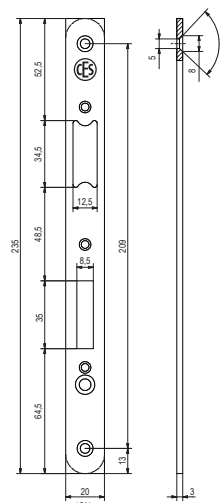
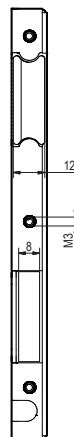
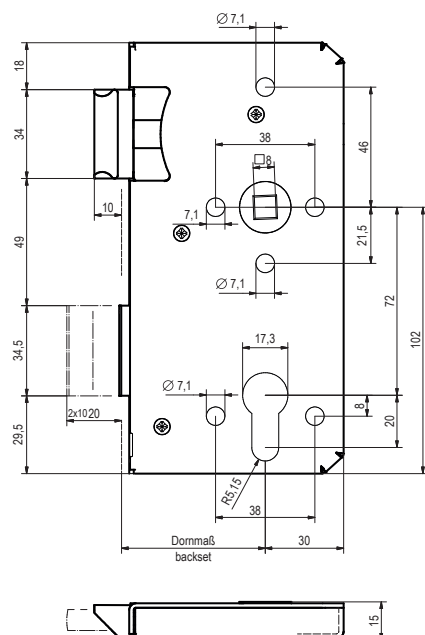

Art.No. 0725

CES vario for solid leaf doors

Type	Description/features
0701	Renovation lock-body with shortened lock case (153 mm) prepared for profile cylinder, with transmission bar only backset 55 mm, centre distance 72 mm, 8 mm follower borne in galvanized steel rings, steel latch bolt and steel dead bolt, nickel-plated
0702	Renovation lock-body with shortened lock case (153 mm) for bathrooms with 8 mm dead-bolt follower, only backset 55 mm, centre distance 78 mm, 8 mm follower borne in galvanized steel rings, steel latch bolt and steel dead bolt (single-turn 15 mm), nickel-plated
0705	Industrial-building lock-body according to DIN 18251-1, class 3 prepared for profile cylinder, with transmission bar backset 55 (60, 65, 70, 80, 90, 100) mm, centre distance 72 mm, 8 (9) mm follower borne in galvanized steel rings, steel latch bolt and steel dead bolt, nickel-plated
0706	Industrial-building lock-body according to DIN 18251-1, class 3 for bathrooms with 8 mm dead-bolt follower, backset 55 (60, 65, 70, 80, 90, 100) mm, centre distance 78 mm, 8 (9) mm follower borne in galvanized steel rings, steel latch bolt and steel dead bolt (single-turn 15 mm), nickel-plated
	all lock-bodies including: stainless fixing screws for fitting forends



Art.No. 0701



Art.No. 0702



Art.No. 0705



Art.No. 0706

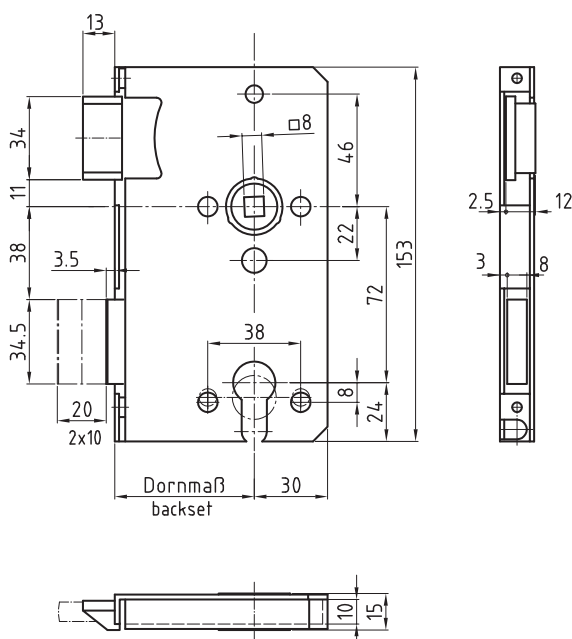

Art.No. 0701

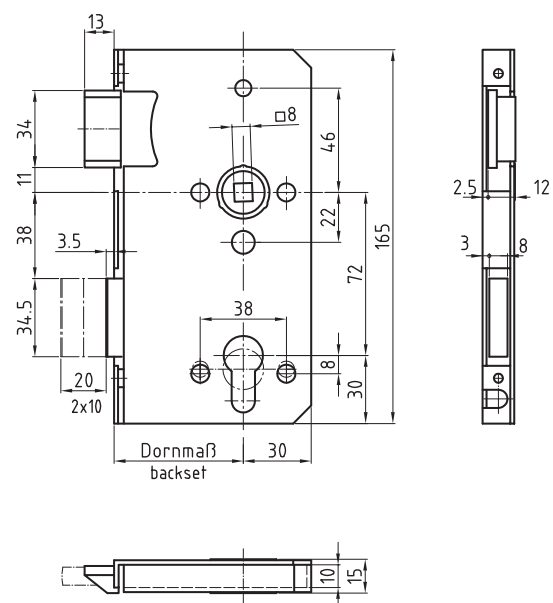

Art.No. 0705

CES vario for solid leaf doors

Type	Description/features
0731	Fitting forend according to DIN 18251-1 edged or rounded, satin stainless steel, for rebated doors: 18, 20, 22 mm for flush doors: 24 mm Packing unit: 15 pcs. for Bathroom-Lock-body (0702 / 0706) art.-no. 0731WC
0732	Fitting forend according to DIN 18251-1 edged or rounded, brass, polished, for rebated doors: 18, 20, 22 mm, for flush doors: 24 mm, including 2 fixing screws Packing unit: 15 pcs. for Bathroom-Lock-body (0702 / 0706) art.-no. 0732WC



Art.No. 0731



Art.No. 0732

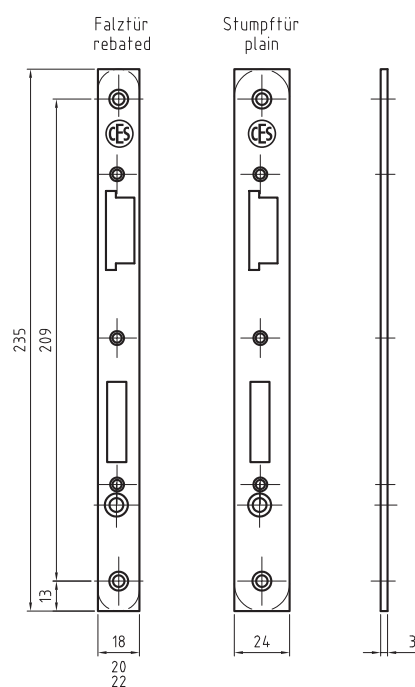



Locks for refurbishment

- CES vario for solid leaf doors
- **CES vario Flex for narrow frame doors**

CVFSTARTSET	CES vario Flex “Starter Set”	66
CVFPROFSET	CES vario Flex “Profi Set”	66
Restocking kit		66
Order form		67

CES vario Flex for narrow frame doors

Type	Description/features
CVFSTARTSET	<p>CES vario Flex „Starter Set“ Modular system for narrow stile mortise locks, Profile cylinder with latch lever (PZW) DIN EN 12209: 2004-03 3M700F2BA30, reversible latch – variable backsets (30, 35, 40 und 45 mm) – variable centre distance (72+92 mm) – variable frame dimension</p> <p>Set includes: 1x lock case with 30 mm backset 4x latch bolt and dead bolt heads per backset 2x spacer strips (5+10 mm) 1x latch bolt guide 2x reducer sleeves (10 to 9 mm and 10 to 8 mm) 1x fitting flat forend 24 mm (centre distance 72 mm) 3x fitting flat forend 16, 20, 24 mm (centre distance 92 mm) 1x fitting U-forend 24x6 mm (centre distance 92 mm) and fixing screws</p>
CVFPROFISET	<p>CES vario Flex „Pro Set“ in robust plastic case Modular system for narrow stile mortise locks, Profile cylinder with latch lever (PZW) DIN EN 12209: 2004-03 3M700F2BA30, reversible latch – variable backsets (30, 35, 40 und 45 mm) – variable centre distance (72+92 mm) – variable frame dimension</p> <p>Set includes: 1x lock case with 30 mm backset 4x latch bolt and dead bolt heads per backset 2x spacer strips (5+10 mm) 1x latch bolt guide 2x reducer sleeves (10 to 9 mm and 10 to 8 mm) 1x fitting flat forend 24 mm (centre distance 72 mm) 3x fitting flat forend 16, 20, 24 mm (centre distance 92 mm) 1x fitting U-forend 24x6 mm (centre distance 92 mm) and fixing screws</p>
Restocking kit	<p>Restocking kit for completing the set comprising: 1x lock case, 1x latch bolt and dead bolt head depending on backset, optionally with spacer strips, 1x latch bolt guide, 1x fitting forend and fixing screws</p> <p>For the article number, please refer to the order form page 67</p>



CES vario Flex

Order form – Please fax or email to +49 2051-204-231 or export@ces.eu
or your known contact person

Please check in all fields which parts you have used up.
Please note that only complete retrofit kits can be supplied.

Customer number	
Company	
Contact for queries	
Date	
Signature/ Stamp	

Reducer sleeve	Please check as applicable
8 mm	
9 mm	

Centre distance	Please check as applicable
72 mm	
92 mm	

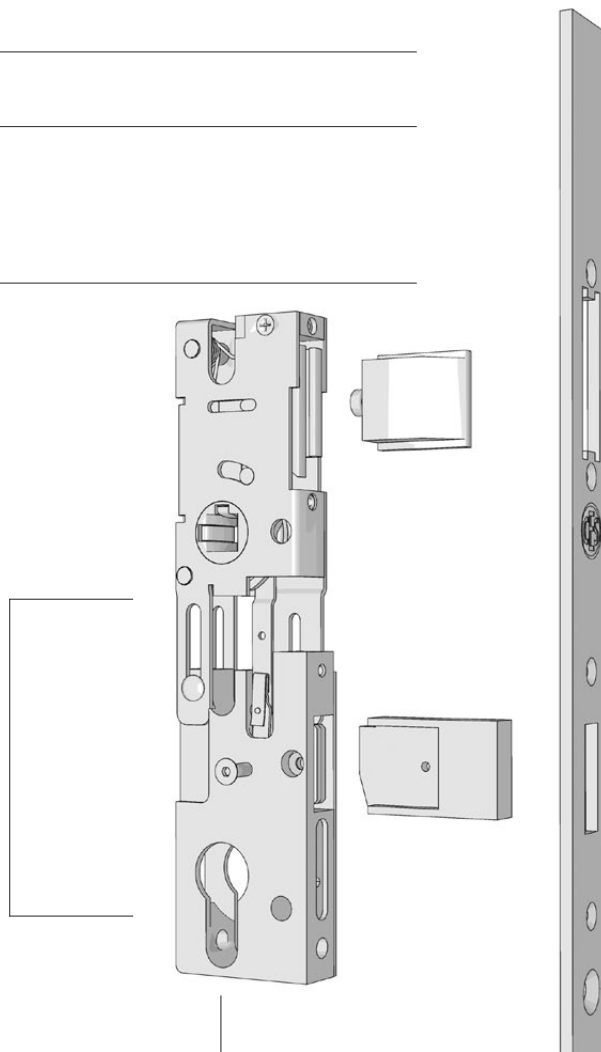

Backset	Please check as applicable	Backset *	Please check as applicable
30 mm		30 +5 mm	
35 mm		35 +5 mm	
40 mm		40 +5 mm	
45 mm		—	—

* Protrusion of latch and dead bolt by 5 mm

Type of forend	Please check as applicable
U-forend	
Flat forend	

Forend dimension	Please check as applicable
16 x 270 mm	
20 x 270 mm	
24 x 270 mm	
Special forend 16 x 350 mm	
Special forend 20 x 350 mm	
Special forend 24 x 350 mm	

You will receive a retrofit kit comprising:

- 1 x lock body
- 1 x latch and dead bolt head
- depending on backset optionally with spacer strips
- 1 x latch bolt guide
- 1 x fitting forend and fixing screws



Striking plates

	Overview “Which striking plate fits which lock?”	70
0400	Angular striking plate for rebated doors	71
0402	Angular striking plate for rebated doors	71
0433	Angular striking plate for rebated doors	72
0439	Angular striking plate for rebated doors	71
0445	Angular striking plate for rebated doors	73
0504	Flat striking plate for flush doors	73
0504-11	Flat striking plate for flush doors	73
0504-16	Flat striking plate for flush doors	73
0507	Striking plate	74
0508	Striking plate	74
0510	Striking plate	75
0511	Striking plate	75
0512	Striking plate	76
0513	Striking plate	76
0514	Striking plate	76
0518	Flat striking plate for flush doors	72
0522	Flat striking plate for flush doors	77
0522-16	Flat striking plate for flush doors	77
0522-17	Flat striking plate for flush doors	77
0522-18	Flat striking plate for flush doors	77
0590	Flat striking plate	77
2524	Striking plate	56
5729	Striking plate	56
5730	Striking plate	57

Overview

“Which striking plate fits which lock?”

Striking plate	Lock
0400	334, 334SL, 390, 390SL, 8230
0402	334, 334SL, 390, 390SL, 8230
0433	8030, 8034
0439	334, 334SL, 390, 390SL, 8230
0445	2500, 300-01, 300-01SL
0504	2500, 300-01, 300-01SL
0504-11	2500, 300-01, 300-01SL
0504-16	
0507	2700, 2730
0508	2700, 2730
0510	4530, 4590
0511	4730, 4790 (without blind groove) 4700 (with blind groove) 4730, 4790 (without blind groove) 4700 (with blind groove)
0512	5530N, 5590
0513	5630
0514	5800, 5830
0518	8030, 8034
0522	334, 334-SL, 390, 390SL, 8230
0522-16	9100, 9100SP, 9100WC, 9100E, 9100E-SP, 77.34, 7734, 7790
0522-17	9100F, 9100FL, 9100F-SP, 7700-01
0522-18	9100R, 7730-02
0590	9034, 9090
2524	5434, 5834, 5630
5729	5434, 5834, 5630
5730	5530

Striking plates

Type	Description/features
0400	Angular striking plate for rebated doors for left-hand and right-hand use, dimensions: 20 x 20 x 170 mm, lacquered, nickel-silver colour
	fitting for article: 334, 334SL, 390, 390SL, 8230
0402	Angular striking plate for rebated doors for left-hand and right-hand use, dimensions: 20 x 8 x 170 mm, lacquered, nickel-silver colour
	fitting for article: 334, 334SL, 390, 390SL, 8230
0439	Angular striking plate for rebated doors with plastic backing, for left-hand and right-hand use, dimensions: 20 x 8 x 170 mm, lacquered in nickel-silver colour
	fitting for article: 334, 334SL, 390, 390SL, 8230



Art.No. 0400



Art.No. 0402



Art.No. 0439

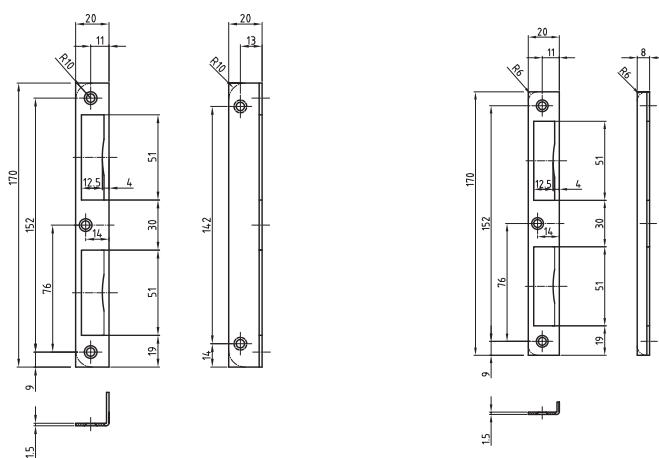

Art.No. 0400

Art.No. 0402

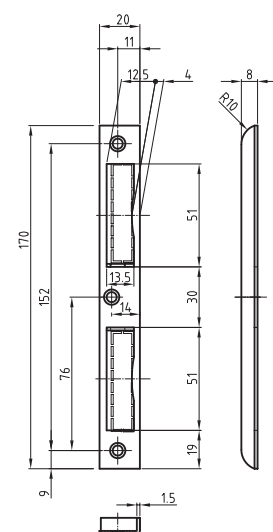

Art.No. 0439

Striking plates

Type	Description/features
0433	Angular striking plate for rebated doors for one-sided use, dimensions: 22 x 25 x 230 mm, only satin stainless steel
	fitting for article: 8030, 8034
0518	Flat striking plate for flush doors for one-sided use, dimensions: 26 (42) x 235 mm, edged, satin stainless steel
	fitting for article: 8030, 8034



Art.No. 0433



Art.No. 0518

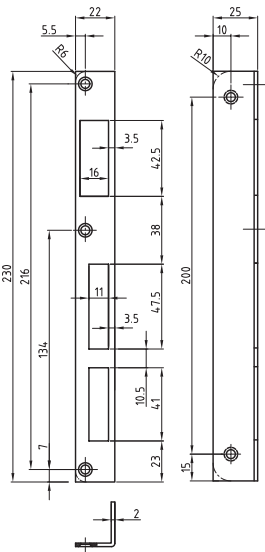

Art.No. 0433

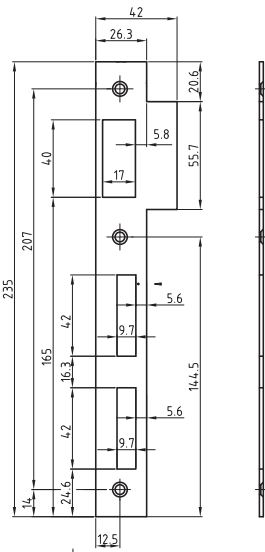

Art.No. 0518

Striking plates

Type	Description/features
0445	Angular striking plate for rebated doors for left-hand and right-hand use, dimensions: 20 x 10 x 100 mm, lacquered in nickel-silver colour
	fitting for article: 2500 and DIN Latch-locks 300-01, 300-01SL
0504	Flat striking plate for flush doors for left-hand and right-hand use, dimensions: 24 (42) x 85 mm, edged or rounded, lacquered in nickel-silver colour
	fitting for article: 2500 and DIN Latch-locks 300-01, 300-01SL
0504-11	Flat striking plate for flush doors for left-hand and right-hand use, with curved lobe, dimensions: 24 (37,5) x 85 mm edged or rounded, lacquered in nickel-silver colour
	fitting for article: 2500 and DIN Latch-locks 300-01, 300-01SL
0504-16	Flat striking plate for flush doors for Mortise latch-locks non-handed, with curved lobe, dimensions: 24 (38) x 85 mm, edged or rounded, lacquered in nickel-silver colour
	fitting for article: 9100F, 9100FL, 9100F-SP, 7700-01, 7734-01



Art.No. 0445



Art.No. 0504



Art.No. 0504-11

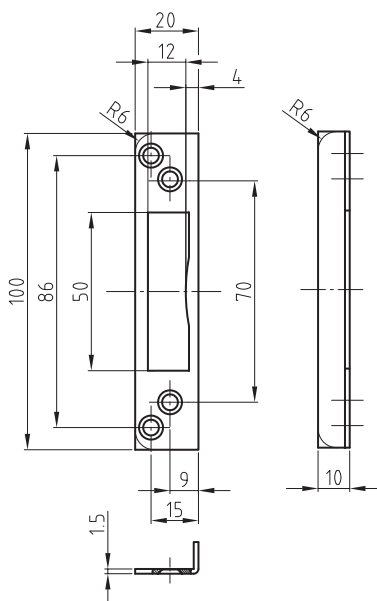

Art.No. 0445

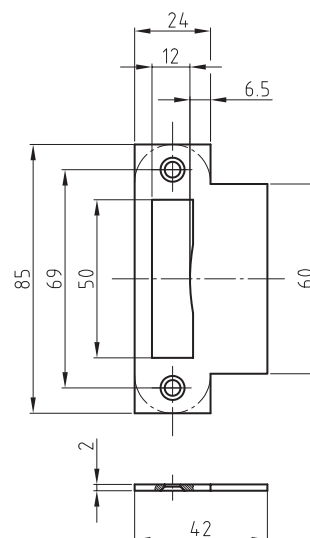

Art.No. 0504

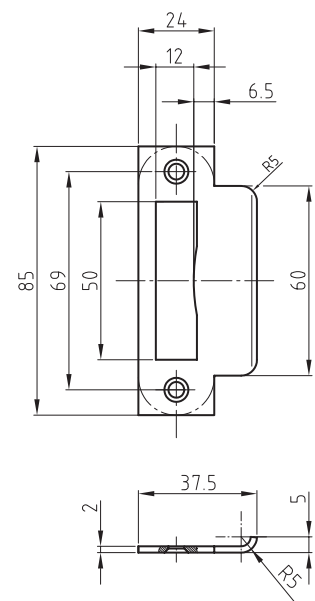

Art.No. 0504-11

Striking plates

Type	Description/features
0507	Striking plate Dimensions: 20 x 85 mm, edged or rounded, lacquered in nickel-silver colour
	fitting for article: 2700, 2730
0508	Striking plate dimensions: 24 x 85 mm edged or rounded, lacquered in nickel-silver colour
	fitting for article: 2700, 2730



Art.No. 0507

Art.No. 0508

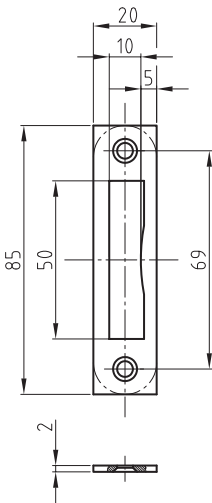

Art.No. 0507

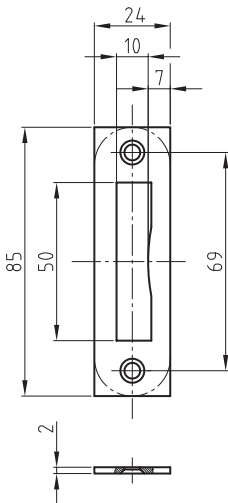

Art.No. 0508

Striking plates

Type	Description/features
0510	Striking plate Dimensions: 24 (42) x 202 mm, edged or rounded, lacquered in nickel-silver colour
	fitting for article: 4530, 4590
0511	Striking plate Dimensions: 24 (42) x 123 mm edged or rounded, lacquered in nickel-silver colour
	fitting for article: 4730, 4790 (without blind groove) 4700 (with blind groove)



Art.No. 0510



Art.No. 0511

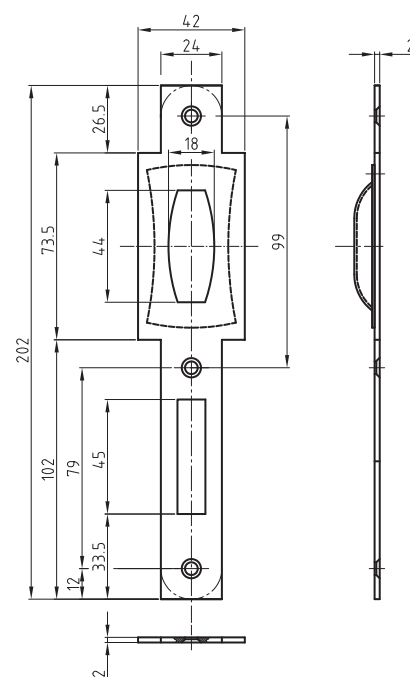

Art.No. 0510

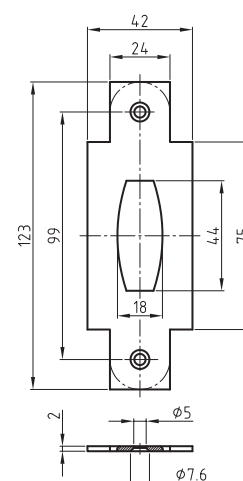

Art.No. 0511

Striking plates

Type	Description/features
0512	Striking plate Dimensions: 20 x 105 mm, edged or rounded, lacquered in nickel-silver colour
	fitting for article: 5530N, 5590
0513	Striking plate Dimensions: 24 x 112 mm, edged, satin stainless steel
	fitting for article: 5630
0514	Striking plate Dimensions: 22 x 112 mm, edged, lacquered in nickel-silver colour
	fitting for article: 5800, 5830



Art.No. 0512

Art.No. 0513

Art.No. 0514

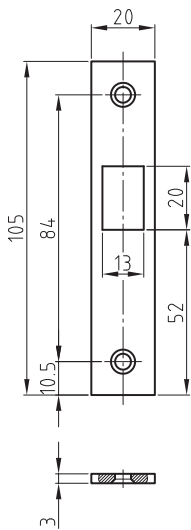

Art.No. 0512

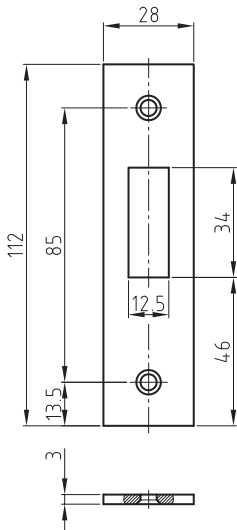

Art.No. 0513

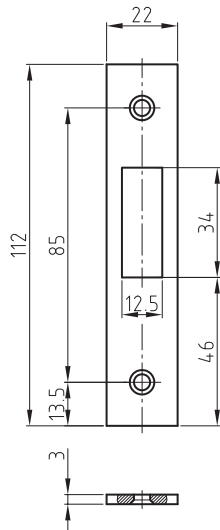

Art.No. 0514

Striking plates

Type	Description/features
0590	Flat striking plate for flush doors Applicable for righthand and lefthand use dimensions: 25 (37) x 200 mm, edged, satin stainless steel or solid brass, polished fitting for article: 9034 and 9090
0522	Flat striking plate for flush doors for one-sided use, dimensions: 24 (42) x 170 mm, edged or rounded, lacquered in nickel-silver colour Version with special lobe width (> 42 mm) fitting for article: 334, 334-SL, 390, 390SL, 8230
0522-16	Flat striking plate for flush doors for one-sided use, with curved lobe, dimensions: 24 (37,5) x 170 mm, edged or rounded, lacquered in nickel-silver colour
0522-17	Flat striking plate for flush doors for Mortise latch-locks non-handed, with curved lobe, dimensions: 24 (38) x 170 mm, edged or rounded, lacquered in nickel-silver colour fitting for article: 9100F, 9100F-SP, 7700-01, 7734-01
0522-18	Flat striking plate for flush doors for Mortise Deadlocks non-handed, with curved lobe, dimensions: 24 (38) x 170 mm, edged or rounded, lacquered in nickel-silver colour fitting for article: 9100R, 7730-02, 7790-02



Art.No. 0590



Art.No. 0522



Art.No. 0522-16 Art.No. 0522-17 Art.No. 0522-18

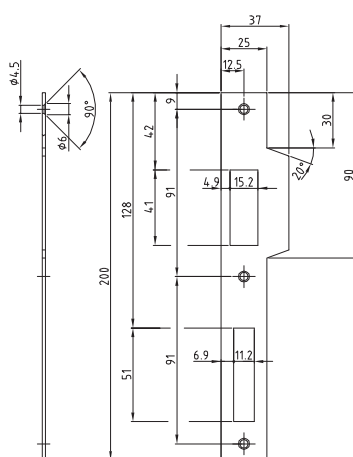

Art.No. 0590

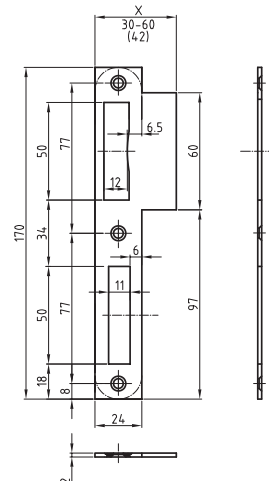

Art.No. 0522

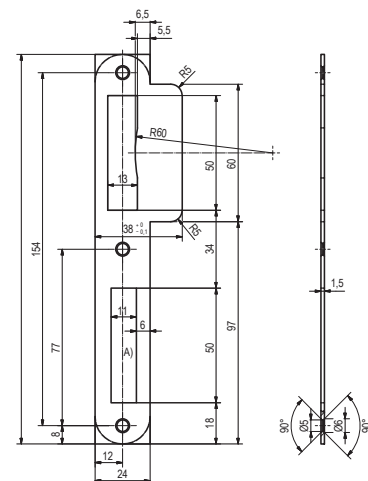

Art.No. 0522-16

Pictograms

Pictograms are used on the article pages to make it easier to select the right lock.

They describe the standard, classification or locking type. Below you will find the meaning of the various pictograms.



- Mortise lock prepared for euro-profile-cylinder
- Mortise lock in bathroom-version
- Mortise lock for formed key



- DIN 18250 Mortise locks for fire doors and smoke control doors
- DIN 18251-1 Mortise locks for rebated doors
- DIN 18251-2 Mortise locks for narrow frame doors



- DIN EN 1125 Panic exit devices operated by a horizontal bar, for use on escape routes
 - DIN EN 12209 Mechanically operated locks and striking plates
 - DIN EN 179 Emergency exit devices operated by a lever handle or push pad, for use on escape routes
- Further information: www.ces.eu > Media centre > Installation instructions EN 12209 or Installation instructions EN 179



- Successful fire test to BS EN 1634-1
Timber door 30, 60, 90 and 120 minutes, up to 2 hours
- Steel door 30, 60, 90, 120 and 240 minutes, up to 4 hours



- CE-marked as a visible proof that the fire-rated locks comply with EU requirements

Explanation of DIN direction

The opening direction of doors (opening left or right) is relevant for the selection of the lock, unless it is a lock that can be used on both sides.

Depending on the type of hinge - i.e. the side where the hinges are located - a distinction is made between left-opening doors (DIN left/ISO 6 Door) and right-opening doors (DIN right/ISO 5 Door).

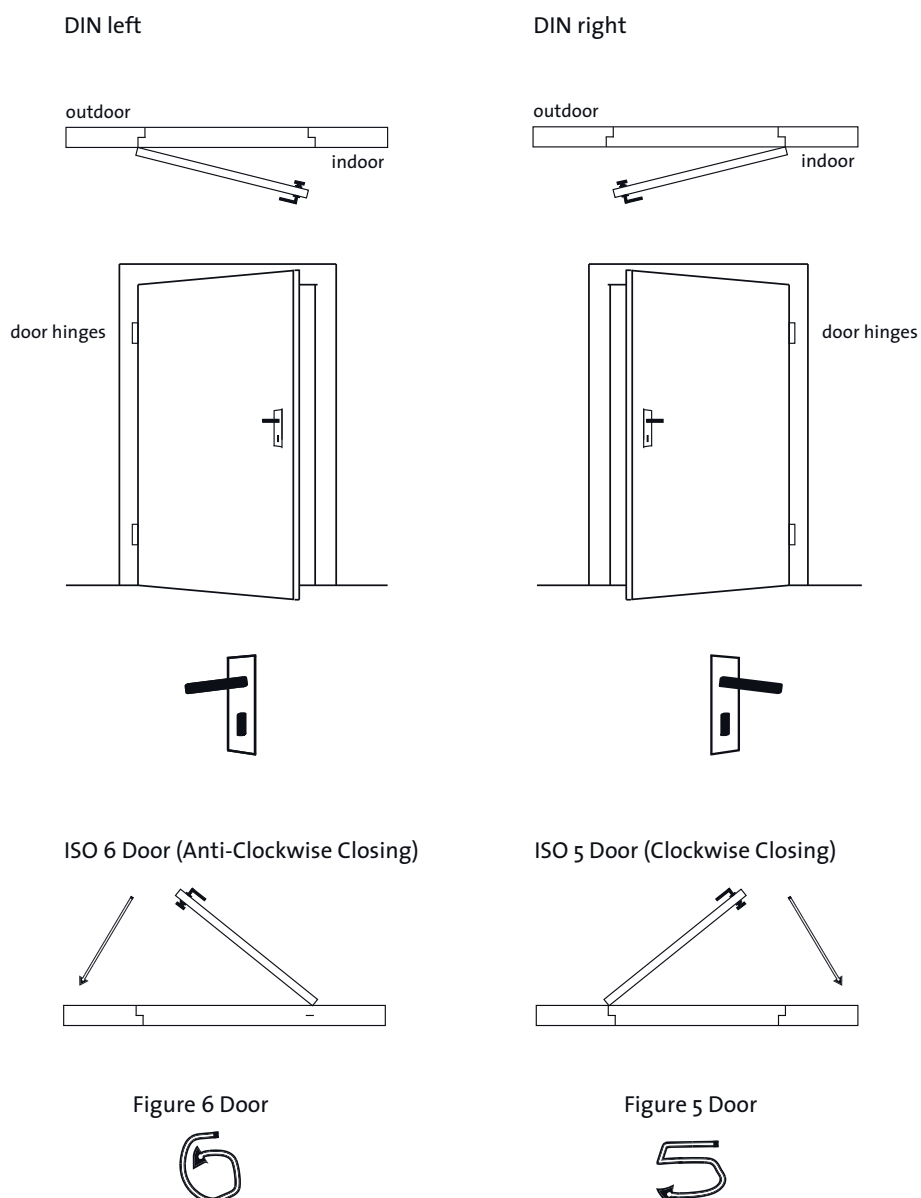

Blank lined area for writing.



C.Ed. Schulte GmbH
Zylinderschlossfabrik

Friedrichstraße 243

D-42551 Velbert

☎ +49 2051 204 0

☎ +49 2051 204 229

@ info@ces.eu